



PART 4i: DAMBUS

by

maker KUSYIADI,

(Pangkalpinang, Bangka)

More info about the remnant monoxyle lutes in my topical chapters below:

http://inthegapbetween.free.fr/pierre/GAMBUS_PROJECT/01_qanbus-au-yemen.pdf (coming soon)
http://inthegapbetween.free.fr/pierre/GAMBUS_PROJECT/02_gambus_swahili_coast_and_comoros.pdf
http://inthegapbetween.free.fr/pierre/GAMBUS_PROJECT/04_gambus-au-alam_melayu.pdf
http://inthegapbetween.free.fr/pierre/GAMBUS_PROJECT/05_gambus_a_borneo.pdf
http://inthegapbetween.free.fr/pierre/GAMBUS_PROJECT/06_gambus-au-NTB.pdf
http://inthegapbetween.free.fr/pierre/GAMBUS_PROJECT/07_gambus-au-NTT.pdf
http://inthegapbetween.free.fr/pierre/GAMBUS_PROJECT/08_gambus-au-sulawesi_moluccas.pdf
http://inthegapbetween.free.fr/pierre/GAMBUS_PROJECT/99_BANGSAWAN-&-HAMDOLOK.pdf

More info about lutery manufacturing in my chapters below:

http://inthegapbetween.free.fr/pierre/PROCESS_PROJECT/process_qanbus.pdf
http://inthegapbetween.free.fr/pierre/PROCESS_PROJECT/process_javanese_bambu_gambus.pdf
http://inthegapbetween.free.fr/pierre/PROCESS_PROJECT/process_malay_gambus_seludang_wooden.pdf
http://inthegapbetween.free.fr/pierre/PROCESS_PROJECT/process_malay_gambus_Hadramawt.pdf
http://inthegapbetween.free.fr/pierre/PROCESS_PROJECT/process_malay_gambus_hijaz_skin.pdf
http://inthegapbetween.free.fr/pierre/PROCESS_PROJECT/process_dambus_bangka.pdf
http://inthegapbetween.free.fr/pierre/PROCESS_PROJECT/process_panting_lute_kalimantan.pdf
http://inthegapbetween.free.fr/pierre/PROCESS_PROJECT/process_baglama.pdf
http://inthegapbetween.free.fr/pierre/PROCESS_PROJECT/process_oud.pdf
http://inthegapbetween.free.fr/pierre/PROCESS_PROJECT/process_tar.pdf
http://inthegapbetween.free.fr/pierre/PROCESS_PROJECT/process_setar.pdf
http://inthegapbetween.free.fr/pierre/PROCESS_PROJECT/process_santour.pdf

Yemeni items

- Item 001 San'a (exile)
- Item 002 San'a
- Item 003 San'a
- Item 004 maker QUTURI Al-Ajami's, San'a
- Item 005 San'a
- Item 006 San'a
- Item 007 San'a
- Item 008 San'a
- Item 009 Al-Nunu's, San'a
- Item 010 San'a
- Item 011 replica Loopuyt
- Item 012 House of Culture, San'a
- Item 013 Al-Jumai's, San'a
- Item 014 Al-Harithi's , San'a / Abdelbaset Al-Hareshi
- Item 015 maker QUTURI Mokrani's , San'a
- Item 016 maker QUTURI Mokrani's , San'a
- Item 017 San'a curio, San'a
- Item 018 Edimburgh museum, UK
- Item 019 Metropolitan museum, NYC, USA
- Item 020 Awni / Hasan Al-Ajami's, San'a
- Item 021 maker QUTURI /Jeff Greene, NYC, USA
- Item 022 Metropolitan museum, NYC, USA
- Item 023 Santa Cecilia auditorium, Italy
- Item 024 Metropolitan museum, NYC, USA
- Item 025 Najat Baraka's , San'a
- Item 026 Metropolitan museum, NYC, USA
- Item 027 unknown San'a,
- Item 028 Hijaz (Leiden museum),
- Item 029 maker QUTURI, 2013
- Item 030 Hijaz (ebay),
- Item 031 Replica (Cronier, Burkina),
- Item 032 replica Loopuyt (2)
- Item 033 unknown San'a,
- Item 034 maker QUTURI /Ahmed AT-TASHI
- Item 035 maker QUTURI /Ahmed AT-TASHI
- Item 036 maker QUTURI /Ahmed AT-TASHI
- Item 037 maker QUTURI /Ahmed AT-TASHI
- Item 038 San'a
- Item 039 maker QUTURI /Ahmed AT-TASHI
- Item 040 maker QUTURI / Muhammad HEJRI (Cairo)
- Item 041 maker QUTURI / Ugo NASTRUCCI (Italia)
- Item 042 Yemen ? (Werner FORMAN)
- Item 043 Art Gemeente museum, Ther Hague
- Item 044 maker QUTURI /San'a
- Item 045 Hartenberger World Collection

Swahili items

- Item 101 Zanzibar
- Item 102 replica Mombasa
- Item 103 Mombasa
- Item 104 tanzanian coast
- Item 105 Mwanza, Tanzania
- Item 106 Mwanza, Tanzania
- Item 107 Quwaytara, Zanzibar
- Item 108 Kenya (Leiden museum)
- Item 109 Kenya/Tanzania? (ebay)
- Item 110 "Mgodro group", Zanzibar
- Item 111 Swahili (Teater Museum, Stockholm)
- Item 112 Tanzania (British museum)
- Item 113 Mozambique ? (museum Aberdeen)

Comorian Items

- Item 201 Domoni, East Nzuani isl.
- Item 202 Nzuani isl.
- Item 203 Sima, West Nzuani isl.
- Item 205 NW Madagascar
- Item 206 NW Madagascar
- Item 207 NW Madagascar
- Item 208 NW Madagascar
- Item 209 NW Madagascar
- Item 210 Mwali
- Item 211 Domoni, East Nzuani isl.
- Item 215 Mjamawe, N Nzuani
- Item 216 Domoni, East Nzuani isl.
- Item 217 Domoni, East Nzuani isl.
- Item 219 Mwali
- Item 220 Mwali
- Item 221 Mwali
- Item 222 Domoni, East Nzuani isl.
- Item 223 Mjamawe, N Nzuani
- Item 226 Mwali ? / Scottsdale museum, AZ
- Item 227 Diego Suarez, Madagascar
- Item 228 Domoni, East Nzuani isl.
- Item 229 Domoni, East Nzuani isl.
- Item 230 Domoni, East Nzuani isl.
- Item 231 Mjamawe, N Nzuani
- Item 232 Domoni, East Nzuani isl.
- Item 233 Mwali
- Item 234 NW Madagascar (Leiden Museum)
- Item 235 Mwali
- Item 236 Mwali
- Item 237 Mwali
- Item 238 Chagaga, Domoni, East Nzuani isl.
- Item 239 Domoni, East Nzuani isl.
- Item 240 Domoni, East Nzuani isl.
- Item 241 Mutsamudu, Nzuani isl.
- Item 242 Domoni?, East Nzuani isl.
- Item 243 Domoni?, East Nzuani isl.
-

Mahore Island Items (french Comoro)

- Item 501 Boueni, South Mahore
- Item 502 Mr Linibwe, Mahore
- Item 503 Tsararano, East Mahore
- Item 504 Tsararano, East Mahore
- Item 505 Chirongui, S-W Mahore
- Item 506 "Tsounga", Mahore?
- Item 507 (Klan Demba) Chiconi, W Mahore
- Item 508 (Gabus café) Chiconi, W Mahore
- Item 509 Chiconi, W Mahore
- Item 510 Acoua, NW Mahore
- Item 511 Msangamuji, NW Mahore
- Item 512 Chiconi, W Mahore
- Item 513 Chiconi, W Mahore
- Item 514 Acoua ?, N W Mahore
- Item 515 Chiconi, W Mahore
- Item 516 Tsoundzou, W Mahore
- Item 517 Msangamuji, NW Mahore
- Item 518 Mwali / Dzoumogne
- Item 519 Baco / Bandrélé ??
- Item 520 Chirongui, S-W Mahore
- Item 521 Chiconi, W Mahore
- Item 522 Mwali / Passamainty
- Item 523 Chiconi, W Mahore
- Item 524 Dzoumogne, N-E Mahore
- Item 525 Chirongui, S-E Mahore
- Item 526 Chiconi, W Mahore
- Item 531 Chiconi, W Mahore
- Item 532 Msangamuji ?, W Mahore
- Item 533 Msangamuji ?, W Mahore
- Item 534 Msangamuji ?, W Mahore
- Item 535 Chiconi, W Mahore
- Item 536 Chirongui, S-W Mahore
- Item 537 Chiconi, W Mahore
- Item 538 Chiconi?, W Mahore
- Item 539 Chiconi, W Mahore
- Item 540 Msangamuji ?, W Mahore
- Item 541 Chiconi, W Mahore (ASSU)
- Item 542 Chirongui, S-W Mahore
- Item 543 Bandrélé, S-E Mahore
- Item 544 Chirongui, S-W Mahore
- Item 545 Chirongui, S-W Mahore
- Item 546 replica Burkina Faso
- Item 547 Chirongui?, S-W Mahore
- Item 548 maker BAYNA, Kaweni, Mahore
- Item 549 Chiconi, W Mahore (Comité)
- Item 550 Chiconi, W Mahore)
- Item 551 Chiconi, W Mahore
- Item 552 Choco, Chiconi, W Mahore
- Item 553 Chirongui, S-W Mahore
- Item 554 Acoua / Chirongui?, W Mahore
- Item 555 Unknown location in Mahore
- Item 556 Mirereni, central Mahore
- Item 557 maker BAYNA, Kaweni, Mahore
- Item 558 maker BAYNA, Kaweni, Mahore
- Item 559 maker J.WELLERS, Mtsapere, Mahore
- Item 560 maker J.WELLERS, Mtsapere, Mahore
- Item 561 maker J.WELLERS, Mtsapere, Mahore
- Item 562 maker J.WELLERS, Mtsapere, Mahore
- Item 563 maker J.WELLERS, Mtsapere, Mahore
-
-

http://inthegapbetween.free.fr/pierre/GAMBUS/PROJECT/04a_PORTFOLIO_part4a.pdf
http://inthegapbetween.free.fr/pierre/GAMBUS/PROJECT/04c_PORTFOLIO_part4c.pdf
http://inthegapbetween.free.fr/pierre/GAMBUS/PROJECT/04e_PORTFOLIO_part4e.pdf
http://inthegapbetween.free.fr/pierre/GAMBUS/PROJECT/04f_PORTFOLIO_part4f.pdf
http://inthegapbetween.free.fr/pierre/GAMBUS/PROJECT/04k_PORTFOLIO_part4k.pdf
http://inthegapbetween.free.fr/pierre/GAMBUS/PROJECT/04l_PORTFOLIO_part4l.pdf
http://inthegapbetween.free.fr/pierre/GAMBUS/PROJECT/04m_PORTFOLIO_part4m.pdf
http://inthegapbetween.free.fr/pierre/GAMBUS/PROJECT/04m2_PORTFOLIO_part4m2.pdf
http://inthegapbetween.free.fr/pierre/GAMBUS/PROJECT/04m3_PORTFOLIO_part4m3.pdf
http://inthegapbetween.free.fr/pierre/GAMBUS/PROJECT/04m4_PORTFOLIO_part4m4.pdf

PART4a : ALAM MELAYU : NORTH SUMATRA

PART4c : ALAM MELAYU : LAMPUNG & ISIANDS

PART4e : ALAM MELAYU : RIAU

PART4f : ALAM MELAYU : LESS-KNOWN RIAU: BENGKALIS

PART4f2: ALAM MELAYU : LESS-KNOWN RIAU: MERANTI

PART4fk: ALAM MELAYU : LESS-KNOWN RIAU: HINDRA GIRI

- Item 300 KePri/ Riau island, China Sea
- Item 301 Batak, Sumatra
- Item 302 Riau, Sumatra
- Item 303 Bengkulu?, Sumatra
- Item 304 undefined, Sumatra
- Item 305 Riau, Sumatra
- Item 306 Bengkulu, Riau dct.
- Item 307 Bengkulu, Riau dct.
- Item 308 Penyangat (Riau isl)
- Item 309 Penyangat (Riau isl)
- Item 310 SE Sumatra
- Item 311 Medan, N. Sumatra
- Item 312 Medan, N. Sumatra
- Item 313 Medan ?, N. Sumatra
- Item 314 Medan, N. Sumatra
- Item 315 Kayu Agung, SE. Sumatra
- Item 316 Palembang, SE. Sumatra
- Item 317 Indonesia (tropenmuseum)
- Item 318 Indonesia (tropenmuseum)
- Item 319 Indonesia (tropenmuseum)
- Item 320 Riau, Indonesia.
- Item 321 Siak? Riau dct, Sumatra.
- Item 322 Mr Khairul Asrar, Riau
- Item 323 Firdaus in Siak, Riau dct, Sumatra.
- Item 324 Firdaus in Siak, Riau dct, Sumatra
- Item 325 Sungwai Rawa, Riau dct, Sumatra.
- Item 326 Riau dct, Sumatra.
- Item 327 Riau dct, Sumatra.(Indonesia heritage.org)
- Item 328 Sumatra.Selatan (Indonesia heritage.org)
- Item 329 Medan, N. Sumatra
- Item 330 Medan, N. Sumatra
- Item 331 Bengkulu, Sumatra.
- Item 332 Lampung, SE Sumatra
- Item 333 Jambi Isl, SE Sumatra
- Item 334 Jambi Isl, SE Sumatra
- Item 335 Jambi Isl, SE Sumatra
- Item 336 Jambi, SE Sumatra
- Item 337 Lampung, SE Sumatra
- Item 338 Lunik / Lampung, SE Sumatra
- Item 339 Lampung, SE Sumatra.(Indonesia heritage.org)
- Item 340 Jambi, SE Sumatra (Indonesia heritage.org)
- Item 341 Deli Serdang, Medan, N. Sumatra
- Item 342 Toba Art cases
- Item 343 Toba Art cases. (ebay sale)

- Item 344 Toba Art cases, Vancouver museum
- Item 345 Minangkabau (Leiden museum)
- Item 346 Lampung, SE Sumatra
- Item 347 Jambi Isl, SE Sumatra
- Item 348 Lampung, SE Sumatra
- Item 349 Riau, Sumatra
- Item 34A Lampung, Sumatra
- Item 34B Lampung, Sumatra
- Item 34C Lampung, Sumatra
- Item 34D Jambi Isl, SE Sumatra
- Item 34E Lampung, Sumatra
- Item 34F Lampung, Sumatra
-
- Item 350 Indragiri Hulu, Riau, Sumatra
- Item 351 Pulau Mas. Sapat, S-E Riau, Sumatra
- Item 352 Medan, N. Sumatra
- Item 353 Medan, N. Sumatra
- Item 354 Medan, N. Sumatra
- Item 355 Riau, Sumatra
- Item 356 pulau Lunik, Sumatra
- Item 357 Indragiri Hulu, Riau, Sumatra
- Item 358 Lampung, Sumatra
- Item 359 Riau, Sumatra
- Item 360 Riau, Sumatra
- Item 361 Bengkulu, Riau dct.
- Item 362 Pekanbaru, Riau, Sumatra
- Item 363 Robitah, Pekanbaru, Riau, Sumatra
- Item 364 Robitah, Pekanbaru, Riau, Sumatra
- Item 365 Robitah, Pekanbaru, Riau, Sumatra
- Item 366 Robitah, Pekanbaru, Riau, Sumatra
- Item 367 Firdaus in Siak, Riau dct, Sumatra.
- Item 368 Pekanbaru, Riau, Sumatra
- Item 369 Pekanbaru, Riau, Sumatra
- Item 370 Siak, Riau, Sumatra
- Item 371 Suhani Durhaka, Riau, Sumatra
- Item 372 Robitah, Pekanbaru, Riau, Sumatra
- Item 373 Robithah, Pekanbaru, Riau, Sumatra
- Item 374 Robithah, Pekanbaru, Riau, Sumatra
- Item 375 Siak, Riau, Sumatra
- Item 376 Lampung, Sumatra
- Item 377 Tanjung Batu, Riau Isl Sumatra
- Item 378 Dumai, Bengkulu, Sumatra
- Item 379 Ryan SYAPUTRA, Kepri, Riau Isl, Sumatra
- Item 380 Ryan SYAPUTRA, Kepri, Riau Isl, Sumatra
- Item 381 Ryan SYAPUTRA, Kepri, Riau Isl, Sumatra
- Item 382 Indragiri Hulu, Riau, Sumatra
- Item 383 Indragiri Hulu, Riau, Sumatra
- Item 384 Indragiri Hulu, Riau, Sumatra
- Item 385 Siak, Riau dct, Sumatra.
- Item 386 Pekanbaru, Riau, Sumatra
- Item 387 Pekanbaru, Riau, Sumatra
- Item 388 Bintan Isl, Riau arch., Sumatra
- Item 389 Jambi Isl, SE Sumatra
- Item 390 Riau, Sumatra
- Item 390 Riau, Sumatra
- Item 391 Lampung, Sumatra
- Item 392 Lampung, Sumatra
- Item 393 Lampung, Sumatra
- Item 394 Lampung, Sumatra
- Item 395 Robithah, Pekanbaru, Riau, Sumatra
- Item 396 Robithah, Pekanbaru, Riau, Sumatra
- Item 397 Robithah, Pekanbaru, Riau, Sumatra
- Item 398 Indragiri Hulu, Riau, Sumatra
- Item 399 S. Lampung, SE Sumatra
- Item 400 Indragiri Hulu, Riau, Sumatra

- Item 401 Indragiri Hulu, Riau, Sumatra
- Item 402 Bengkulu, Riau, Sumatra
- Item 403 Pulau Rupat, Bengkulu, Riau, Sumatra
- Item 404 Bengkulu, Riau, Sumatra
- Item 405 Tanjung Pinang, Riau Isl Sumatra
- Item 406 Medan?, Sumatra
- Item 407 Batam, Riau Isl Sumatra
- Item 408 Sungai Apit, Riau, Sumatra
- Item 409 Pulau Rupat, Bengkulu, Riau, Sumatra
- Item 410 Natuna Isl, Riau arch. Sumatra
- Item 411 Natuna Isl, Riau arch. Sumatra
- Item 412 Bintan Isl, Riau Isl Sumatra
- Item 413 Lampung, SE Sumatra
- Item 414 Lampung, SE Sumatra
- Item 415 Palembang, SE Sumatra
- Item 416 Medan ?, N. Sumatra
- Item 417 Pariaman, W. Sumatra
- Item 418 Robithah, Pekanbaru, Riau, Sumatra
- Item 419 Kampung Zapin, Bengkulu, Riau dct.
- Item 420 Robithah, Pekanbaru, Riau, Sumatra
- Item 421 Medan ?, N. Sumatra
- Item 422 Indragiri Hulu, Riau, Sumatra
- Item 423 Robithah, Pekanbaru, Riau, Sumatra
- Item 424 P. Saugi, Meranti Isl, Riau, Sumatra
- Item 425 Meranti ?, Riau, Sumatra
- Item 426 Siak?, Riau dct, Sumatra.
- Item 427 Robithah, Pekanbaru, Riau, Sumatra
- Item 428 Robithah, Pekanbaru, Riau, Sumatra
- Item 429 Bengkulu, Sumatra
- Item 430 Bengkulu, Sumatra
- Item 431 Bengkulu, Sumatra
- Item 432 Indragiri Hulu, Riau, Sumatra
- Item 433 Riau, Sumatra
- Item 434 Riau, Sumatra
- Item 435 Riau, Sumatra
- Item 436 Siak, Riau, Sumatra
- Item 437 Palembang, Sumatra
- Item 438 Palembang, Sumatra
- Item 439 Palembang, Sumatra
- Item 440 Palembang, Sumatra
- Item 441 Tanjung Pinang, Riau Isl Sumatra
- Item 442 Indragiri Hulu, Riau, Sumatra
- Item 443 Indragiri Hulu, Riau, Sumatra
- Item 444 Lampung, SE Sumatra
- Item 445 Lampung, SE Sumatra
- Item 446 Indragiri Hulu, Riau, Sumatra
- Item 447 Riau, Sumatra
- Item 448 Siak, Riau, Sumatra
- Item 449 Medan, N. Sumatra
- Item 450 Medan, N. Sumatra

- Item 451 unknown, Sumatra
- Item 452 Sumatra (Gemeente Museum, The Hague)
- Item 453 Lampung, Sumatra
- Item 454 Bintan Isl, Riau arch., Sumatra
- Item 455 Lampung, Sumatra
- Item 456 Lampung, Sumatra
- Item 457 Pasar Liwa, Lampung, Sumatra
- Item 458 Pesawaran, Lampung, Sumatra
- Item 459 Lampung, Sumatra
- Item 460 Lampung, Sumatra
- Item 461 Lampung, Sumatra
- Item 462 Lampung, Sumatra
- Item 463 Lampung, Sumatra
- Item 464 Pasar, Kuatan Sisingi, Riau, Sumatra
- Item 465 Lampung, Sumatra
- Item 466 Lampung, Sumatra
- Item 467 Meranti Isl, Riau, Sumatra
- Item 468 Meranti Isl, Riau, Sumatra
- Item 469 Bengkalis, Riau dct.
- Item 470 Lampung, Sumatra
- Item 471 Jambi Isl, SE Sumatra
- Item 472 Indragiri Hulu, Riau, Sumatra
- Item 473 Palembang, Sumatra
- Item 474 Palembang, Sumatra
- Item 475 Siak, Riau, Sumatra
- Item 476 Rupa, Bengkalis, Riau dct.
- Item 477 Lampung, Sumatra
- Item 479 Bengkalis, Riau dct.
- Item 479 Indragiri Hulu, Riau, Sumatra
- Item 480 Indragiri Hulu, Riau, Sumatra
- Item 481 Indragiri Hulu, Riau, Sumatra
- Item 482 Palembang, Sumatra
-

http://intheqapbetween.free.fr/pierre/GAMBUS/PROJECT/04b_PORTFOLIO_part4b.pdf

PART4b : ALAM MELAYU : MALAYSIA MAINLAND

- Item M00 Musée de Genève
- Item M01 Malacca
- Item M02 Batu Pahat, Johor
- Item M03 Batu Pahat, Johor
- Item M04 Batu Pahat, Johor
- Item M05 Batu Pahat, Johor
- Item M06 Metropolitan Museum, NYC
- Item M07 Malaysia / Scottsdale museum, AZ
- Item M08 Baling?, Sth Kedah, Malaysia
- Item M09 Johor, Malaysia (archive)
- Item M10 Batu Pahat, Johor
-
- Item M14 Kasiman, Johor Bahru
- Item M15 Johor ?
- Item M16 Johor Baru, Johor
- Item M17 : Fadzil Ahmad, Johor
- Item M18 : Kasiman, Johor Bahru
- Item M19 : Kasiman, Johor Bahru
- Item M20 : Kasiman, Johor Bahru
- Item M22 Malacca
- Item M23 Malaysia
- Item M24 Malaysia (Singapore museum)

http://intheqapbetween.free.fr/pierre/GAMBUS/PROJECT/04d_PORTFOLIO_part4d.pdf
http://intheqapbetween.free.fr/pierre/GAMBUS/PROJECT/04d2_PORTFOLIO_part4d2.pdf
http://intheqapbetween.free.fr/pierre/GAMBUS/PROJECT/04d3_PORTFOLIO_part4d3.pdf
http://intheqapbetween.free.fr/pierre/GAMBUS/PROJECT/04d4_PORTFOLIO_part4d4.pdf
http://intheqapbetween.free.fr/pierre/GAMBUS/PROJECT/04d5_PORTFOLIO_part4d5.pdf
http://intheqapbetween.free.fr/pierre/GAMBUS/PROJECT/04g_PORTFOLIO_part4g.pdf
http://intheqapbetween.free.fr/pierre/GAMBUS/PROJECT/04g2_PORTFOLIO_part4g2.pdf
http://intheqapbetween.free.fr/pierre/GAMBUS/PROJECT/04g3_PORTFOLIO_part4g3.pdf
http://intheqapbetween.free.fr/pierre/GAMBUS/PROJECT/04i_PORTFOLIO_part4i.pdf
http://intheqapbetween.free.fr/pierre/GAMBUS/PROJECT/04n_PORTFOLIO_part4n.pdf

PART4D, G, H & I : DAMBUS in BANGKA & BELITUNG

- Item D00 Mulkan, Rangkui, Bangka Isl
- Item D01 Mulkan, Rangkui, Bangka Isl
- Item D02 Mulkan, Rangkui, Bangka Isl
- Item D03 Pak Usni, Belitung Isl, SE Sumatra
- Item D04 Pak Usni, Belitung Isl, SE Sumatra
- Item D05 Pak Usni, Belitung Isl, SE Sumatra
- Item D06 Bangka, SE Sumatra
- Item D07 Mulkan, Rangkui, Bangka Isl
- Item D08 Kusiyadi, Panang, Bangka Isl, SE Sumatra
- Item D09 Kusiyadi, Panang, Bangka Isl, SE Sumatra
- Item D10 Kusiyadi, Panang, Bangka Isl, SE Sumatra
- Item D11 maker SUKINO, Belitung Isl, SE Sumatra
- Item D12 Bangka Isl, SE Sumatra
- Item D13 Pak Usni, Belitung Isl, SE Sumatra
- Item D14 Bangka, SE Sumatra
- Item D15 Bangka, SE Sumatra
- Item D16 Bangka, SE Sumatra
- Item D17 Kusiyadi, Panang, Bangka Isl, SE Sumatra
- Item D18 Kusiyadi, Panang, Bangka Isl, SE Sumatra
- Item D19 Pak Usni, Belitung Isl, SE Sumatra
- Item D20 Pak Usni, Belitung Isl, SE Sumatra
- Item D21 Pak Usni, Belitung Isl, SE Sumatra
- Item D22 Pak Usni, Belitung Isl, SE Sumatra
- Item D23 Pak Usni, Belitung Isl, SE Sumatra
- Item D24 Bangka, SE Sumatra
- Item D25 Bangka, SE Sumatra
- Item D26 Bangka, SE Sumatra
- Item D27 Bangka, SE Sumatra
- Item D28 Bangka, SE Sumatra
- Item D29 bass ; Bangka, SE Sumatra
- Item D30 Bangka Isl, SE Sumatra
- Item D31 Bangka Isl, SE Sumatra
- Item D32 Bangka Isl, SE Sumatra
- Item D33 Zarotti, Bangka Isl, SE Sumatra
- Item D34 Zarotti, Bangka Isl, SE Sumatra
- Item D35 Bangka Isl, SE Sumatra
- Item D36 (OLX) Bangka Isl, SE Sumatra
- Item D37 (OLX) Bangka Isl, SE Sumatra
- Item D38 Pak Usni, Belitung Isl, SE Sumatra
- Item D39 Zarotti, Bangka Isl, SE Sumatra
- Item D40 Zarotti, Bangka Isl, SE Sumatra
- Item D41 Zarotti, Bangka Isl, SE Sumatra
- Item D42 Bangka Isl, SE Sumatra
- Item D43 Pak Usni, Belitung Isl, SE Sumatra
- Item D44 Pak Usni, Belitung Isl, SE Sumatra
- Item D45 Zarotti, Bangka Isl, SE Sumatra
- Item D46 Zarotti, Bangka Isl, SE Sumatra
- Item D47 maker SUKINO, Belitung Isl, SE Sumatra
- Item D48 Pak Usni, Belitung Isl, SE Sumatra
- Item D49 Kusukeni, Bangka Isl, SE Sumatra
-

- Item D50 Bangka Isl, SE Sumatra
- Item D51 Pak Usni, Belitung Isl, SE Sumatra
- Item D52 Paksu, Muntok, West Bangka Isl,
- Item D53 Paksu, Muntok, West Bangka Isl,
- Item D54 Paksu, Muntok, West Bangka Isl,
- Item D55 Paksu, Muntok, West Bangka Isl,
- Item D56 Paksu, Muntok, West Bangka Isl,
- Item D57 Zarotti, Bangka Isl, SE Sumatra
- Item D58 Kusiyadi, Panang, Bangka Isl, SE Sumatra
- Item D59 Kusiyadi, Panang, Bangka Isl, SE Sumatra
- Item D60 Paksu, Muntok, West Bangka Isl,
- Item D61 Pak Usni, Belitung Isl, SE Sumatra
- Item D62 Pak AKIL (Zarotti), Bangka Isl, SE Sumatra
- Item D63 Kusiyadi, Panang, Bangka Isl, SE Sumatra
- Item D64 Pak Arfai, Bangka Isl, SE Sumatra
- Item D65 Busmail, Bangka Isl, SE Sumatra
- Item D6D Paksu, Muntok, West Bangka Isl,
- Item D67 Paksu, Muntok, West Bangka Isl,
- Item D68 Belitung Isl, SE Sumatra
- Item D69 Pak Usni, Belitung Isl, SE Sumatra
- Item D70 Zarotti, Bangka Isl, SE Sumatra
- Item D71 Zarotti, Bangka Isl, SE Sumatra
- Item D72 Pak Usni, Belitung Isl, SE Sumatra
- Item D73 Bangka, SE Sumatra
- Item D74 Belitung Isl, SE Sumatra
- Item D75 Bangka, SE Sumatra
- Item D76 Bangka, SE Sumatra
- Item D77 Muntok, Bangka, SE Sumatra
- Item D78 Muntok, Bangka, SE Sumatra
- Item D79 Bangka, SE Sumatra
- Item D80 Muntok, Bangka, SE Sumatra
- Item D81 Zarotti ?, Bangka Isl, SE Sumatra
- Item D82 Zarotti, Bangka Isl, SE Sumatra
- Item D83 Zarotti, Bangka Isl, SE Sumatra
- Item D84 ano, Belitung Isl, SE Sumatra
- Item D85 Ruslan KELANA, Tempilang, W. Bangka Isl
- Item D86 Ruslan KELANA, Tempilang, W. Bangka Isl
- Item D87 Pangkalpinang,, Bangka Isl
- Item D88 Mulkan, Rangkui, Bangka Isl
- Item D89 Toboali, Bangka Isl
- Item D90 West Bangka Isl
- Item D91 Ibul, West Bangka Isl
- Item D92 IBukit Maras, Bangka Isl
- Item D93 Kusiyadi, Panang, Bangka Isl, SE Sumatra
- Item D94 Mulkan, Rangkui, Bangka Isl
- Item D95 Mulkan, Rangkui, Bangka Isl
- tem D96 Mulkan, Rangkui, Bangka Isl
- Item D97 Ruslan KELANA, Tempilang, W. Bangka Isl
- Item D98 Bangka Isl, SE Sumatra
- Item D99 Bangka Isl, SE Sumatra
- Item D9A Desa Puput, N. Bangka Isl
- Item D9B Desa Puput, N. Bangka Isl
- Item D9C Zarotti, Bangka Isl, SE Sumatra
- Item D9D Kusiyadi, Panang, Bangka Isl, SE Sumatra
- Item D9E Zarotti, Bangka Isl, SE Sumatra
- Item D9F Zarotti, Bangka Isl, SE Sumatra
- Item D9G Zarotti, Bangka Isl, SE Sumatra
- Item D9H Bangka Isl, SE Sumatra
- Item D9I Bangka Isl, SE Sumatra
- Item D9J Bangka Isl, SE Sumatra
- Item D9K Bangka Isl, SE Sumatra
- Item D9L Belitung Isl, SE Sumatra
-

PART5 : BORNEO (SABAH / SARAWAK / W. KALIMANTAN)

-
-
-
-
- Item 681 in Salim Batu, N. Kalimantan
- Item 682 Pontianak, W. Kalimantan
- Item 683 Sanggau, W. Kalimantan
- Item 684 Melawi, W. Kalimantan, Bornéo
- Item 685 Melawi, W. Kalimantan, Bornéo
- Item 686 Belitang, W. Kalimantan, Bornéo
- Item 687 Landak, W. Kalimantan, Bornéo
- Item 688 Ketapang, W. Kalimantan, Bornéo
- Item 689 Kota Kinabalu, Sabah, Borneo
- Item 690 Kuching, Sarawak, Borneo
- Item 691 Borneo ?
- Item 692 Borneo ?
- Item 693 Borneo – Metropolitan
- Item 694 bruneians of Papar, Sabah
- Item 696 Sumatra? Kalimantan?, Bornéo
- Item 697 Beaufort, Sabah, Borneo
- Item 698 Brunei, Borneo
- Item 699 Beaufort, Sabah, Borneo
- Item 702 Saratok, Sarawak –H Penghulu
- Item 703 Derawan isl, Sarawak
- Item 704 Sarawak? – Kraftang Muz., Johor
- Item 705 Brunei, Borneo
- Item 706 Brunei, Borneo
- Item 707 Brunei, Borneo
- Item 708 Brunei, Borneo
- Item 709 Brunei, Bornéo
- Item 710 bruneians of Papar, Sabah
- Item 711 Kota Kinabalu, Sabah
- Item 712 bruneians of Weston, Sabah
- Item 713 Lubok Weston, Sabah, Borneo
- Item 714 Sarawak, Bornéo
- Item 715 Membakut, Sabah, Borneo
- Item 716 Weston, Sabah, Borneo
- Item 717 Segayar River, W. Kalimantan, Bornéo
- Item 718 gambus Biawak of Papar, Sabah
- Item 719 Kota Bharu, S. Kalimantan, Bornéo
- Item 720 Rainforrest museum, Kuching
- Item 721 Sekadau, NW Kalimantan
- Item 722 bruneians of Papar, Sabah
- Item 723 (Kecil) bruneians of Papar, Sabah
- Item 724 bruneians of Papar, Sabah
- Item 725 bruneians of Papar, Sabah
- Item 726 bruneians of Papar, Sabah
- Item 727 Kumai, W. Kalimantan
- Item 728 Ketapang, W. Kalimantan
- Item 729 Sanggau, W. Kalimantan
- Item 730 Pontianak, W. Kalimantan
- Item 731 Membakut, Sabah, Borneo
- Item 732 Semala, W. Kalimantan
- Item 733 Jangkang, W. Kalimantan
- Item 734 Kg Mentawit, W. Kalimantan

- Item 735 Sanggau, W. Kalimantan
- Item 736 Sekadau Hilir, NW Kalimantan
- Item 737 Sabah, Bornéo
- Item 738 Sabah, Bornéo
- Item 739 Saratok, Sarawak, Bornéo
- Item 740 Seri Serbang?, Sabah, Bornéo
- Item 741 Seri Serbang, Sabah, Bornéo
- Item 742 Kutai, E. Kalimantan, Bornéo
- Item 743 Sabah, Bornéo
- Item 744 Sabah, Bornéo
- Item 748 Sabah, Bornéo
- Item 749 Landak, W. Kalimantan, Bornéo
- Item 750 maker Osman Ali, Papar, Sabah
- Item 751 maker Osman Ali, Papar, Sabah
- Item 752 maker Osman Ali, Papar, Sabah
- Item 753 Sintang, W. Kalimantan
- Item 754 Sanggar, W. Kalimantan
- Item 755 Brunei, Borneo
- Item 756 Tanjung Selor, Kalimantan
- Item 757 Tumpang Negeri, Kalimantan Barat
- Item 758 Tarakan, N. Kalimantan
- Item 759 Sanggau, W. Kalimantan
- Item 760 Sanggau, W. Kalimantan
- Item 761 Sanggau, W. Kalimantan
- Item 762 Sepauk, W. Kalimantan
- Item 763 Sepauk, W. Kalimantan
- Item 764 Matap/Sanggau, W. Kalimantan
- Item 765 Matap/Sanggau, W. Kalimantan
- Item 766 Matap/Sanggau, W. Kalimantan
- Item 767 Matap/Sanggau, W. Kalimantan
- Item 768 Lingkungan/Beaufort, Sabah
- Item 769 Sanggau, W. Kalimantan
- Item 770 Sanggau, W. Kalimantan
- Item 771 Sintang, W. Kalimantan
- Item 772 Melawi, W Kalimantan
- Item 773 Semporna, E. Sabah, Bornéo
- Item 774 Labuan, Sabah, Bornéo
- Item 775 Sanggau, W. Kalimantan
- Item 776 Sanggau, W. Kalimantan
- Item 777 Tanjung Selor, N. Kalimantan
- Item 778 Tanjung Selor, N. Kalimantan
- Item 779 Tarakan, N. Kalimantan
- Item 780 Meliau, W Kalimantan
- Item 781 Kota Belud, Sabah, Bornéo
- Item 782 Pak Malang, Bongawan, Sabah, Bornéo
- Item 783 Pak Malang, Bongawan, Sabah, Bornéo
- Item 784 Pak Malang, Bongawan, Sabah, Bornéo
- Item 785 Pak Malang, Bongawan, Sabah, Bornéo
- Item 786 Sekadau, W Kalimantan
- Item 787 Sintang, W Kalimantan
- Item 788 Pontianak, W. Kalimantan
- Item 789 Sarawak
- Item 790 Sarawak
- Item 791 Sarawak
- Item 792 Kayong Utara, W. Kalimantan
- Item 793 Pontianak, W. Kalimantan
- Item 794 Pontianak, W. Kalimantan
- Item 795 undefined, W. Kalimantan
- Item 796 Sanggau, W. Kalimantan
- Item 797 Kawit, N. Kalimantan

- Item 798 Pulau Nunukan, N. Kalimantan
- Item 799 Tarakan, N. Kalimantan
- Item 79A Sanggau, W. Kalimantan
- Item 79B Badau, W. Kalimantan
- Item 79C Bekut, W. Kalimantan
- Item 79D Nanga Pinoh Upper Kapuas, W. Kalimantan
-

**PART5 : KOTAWARINGIN & SUKAMARA
(CENTRAL KALIMANTAN)**

-
- Item K16 South Kalimantan
- Item K49 Kotawaringin, SW Kalimantan
- Item K55 South Kalimantan
- Item K56 Kotawaringin, SW Kalimantan
- Item K57 Kotawaringin, SW Kalimantan
- Item K58 Pangkalan Buun, SW Kalimantan
-
- Item K62 Kendawangan, SW Kalimantan
- Item K63 Kotawaringin, SW Kalimantan
- Item K64 Sukamara, SW Kalimantan
- Item K65 Sukamara, Kotawaringin, SW Kalimantan
- Item K66 Sukamara, Kotawaringin, SW Kalimantan
- Item K67 Sukamara, Kotawaringin, SW Kalimantan
- Item K68 Kotawaringin, SW Kalimantan
- Item K69 Sukamara, Kotawaringin, SW Kalimantan
- Item K70 Sukamara, Kotawaringin, SW Kalimantan
- Item K71 Sukamara, Kotawaringin, SW Kalimantan
- Item K72 Sukamara, Kotawaringin, SW Kalimantan
- Item K73 Sukamara, Kotawaringin, SW Kalimantan
- Item K74 Sukamara, Kotawaringin, SW Kalimantan
- Item K75 Sukamara, Kotawaringin, SW Kalimantan
- Item K76 Sukamara, Kotawaringin, SW Kalimantan
- Item K77 Sukamara, Kotawaringin, SW Kalimantan
- Item K78 Kubu, Kumai, SW Kalimantan
- Item K79 Pangkalan Bun , Central Kalimantan
- Item K80 Pangkalan Bun , Central Kalimantan
- Item K81 Pangkalan Bun , Central Kalimantan
- Item K82 Sukamara, Kotawaringin, SW Kalimantan
- Item K83 Pangkalan Bun , Central Kalimantan
-
- Item K86 Sukamara, Kotawaringin, SW Kalimantan
- Item K87 Sukamara, Kotawaringin, SW Kalimantan
- Item K88 Sukamara, Kotawaringin, SW Kalimantan
- Item K89 W. Kotawaringin, SW Kalimantan
- Item K92 Sukamara, Kotawaringin, SW Kalimantan
- Item K97 S? Kalimantan
- Item K98 Pulau Nunukan, N.Kalimantan
- Item K99 Sukamara, Kotawaringin, SW Kalimantan
- Item K9A Maker KITAMA, Kotawaringin Lama,C. Kalimantan
- Item K9B Maker KITAMA, Kotawaringin Lama,C. Kalimantan
- Item K9C Maker KITAMA, Kotawaringin Lama,C. Kalimantan
- Item K9D Maker KITAMA, Kotawaringin Lama,C. Kalimantan
- Item K9E Maker KITAMA, Kotawaringin Lama,C. Kalimantan
- Item K9F Maker KITAMA, Kotawaringin Lama,C. Kalimantan
- Item K9G Maker KITAMA, Kotawaringin Lama,C. Kalimantan
-
-

http://inthegapbetween.free.fr/pierre/GAMBUS_PROJECT/05b_PORTFOLIO_part5b.pc
http://inthegapbetween.free.fr/pierre/GAMBUS_PROJECT/05g_PORTFOLIO_part5g.pc
http://inthegapbetween.free.fr/pierre/GAMBUS_PROJECT/05b2_PORTFOLIO_part5b2
http://inthegapbetween.free.fr/pierre/GAMBUS_PROJECT/05b3_PORTFOLIO_part5b3
http://inthegapbetween.free.fr/pierre/GAMBUS_PROJECT/05b4_PORTFOLIO_part5b4
http://inthegapbetween.free.fr/pierre/GAMBUS_PROJECT/05b5_PORTFOLIO_part5b5
http://inthegapbetween.free.fr/pierre/GAMBUS_PROJECT/05b6_PORTFOLIO_part5b6
http://inthegapbetween.free.fr/pierre/GAMBUS_PROJECT/05b7_PORTFOLIO_part5b7
http://inthegapbetween.free.fr/pierre/GAMBUS_PROJECT/05b8_PORTFOLIO_part5b8

E. KALIMANTAN

-
- Item B00 E. Kalimantan, Bornéo
- Item B01 E. Kalimantan, Bornéo
- Item B02 Tana Paser, E. Kalimantan, Bornéo
- Item B03 Asfian Nur GUSPRADA E. Kalimantan, Bornéo
- Item B04 Rinto TAMPILANG, E. Kalimantan,
- Item B05 Tulu Paser, E. Kalimantan,
- Item B06 Tulu Paser, E. Kalimantan,
- Item B07 Tana Paser, E. Kalimantan, Bornéo
- Item B08 Berau, E. Kalimantan, Bornéo
- Item B09 unclear, E. Kalimantan, Bornéo
- Item B10 Kutai, Samarinda, Kalimantan, Bornéo
- Item B11 Tenggarung, E Kutai Kartanegara,, E. Kalimantan
- Item B12 Muarah Kaman, Kutai Kartanegara,, E. Kalimantan
- Item B13 Tana Paser, E. Kalimantan, Bornéo
- Item B14 Tana Paser, E. Kalimantan, Bornéo
- Item B15 Berau, E. Kalimantan, Bornéo
- Item B16 Talisayan, E. Kalimantan, Bornéo
- Item B17 Segayar River, E. Kalimantan, Bornéo
- Item B18 Tana Paser, E. Kalimantan, Bornéo
- Item B19 Tana Paser, E. Kalimantan, Bornéo
- Item B20 Tenggarung, Kutai Kartanegara,, E. Kalimantan
- Item B21 Kutai, Samarinda, Kutai Kartanegara,, E. Kalimantan
- Item B22 Sangkulirang, Berau, Kalimantan, Bornéo
- Item B23 Kutai, Kutai Kartanegara,, E. Kalimantan
- Item B24 Kutai, Kutai Kartanegara,, E. Kalimantan
- Item B25 Sangkulirang, E. Kalimantan, Bornéo
- Item B26 Tenggarung, Kutai Kartanegara,, E. Kalimantan
- Item B27 Tenggarung, Kutai Kartanegara,, E. Kalimantan
- Item B28 Berau, E. Kalimantan, Bornéo
- Item B29 Jembayan, Kutai Kartanegara,, E. Kalimantan
- Item B30 Belangkor, Tenggarung, Kutai Kartanegara,, E. Kalimantan
- Item B31 Tana Paser, E. Kalimantan, Bornéo
- Item B32 Tana Paser, E. Kalimantan, Bornéo
- Item B33 Sanggata, Kutai, E. Kalimantan, Bornéo
- Item B34 Paser, E. Kalimantan, Bornéo
- Item B35 Tana Paser, E. Kalimantan, Bornéo
- Item B36 Tana Paser, E. Kalimantan, Bornéo
- Item B37 Tulu Paser, E. Kalimantan,
- Item B38 Tulu Paser, E. Kalimantan,
- Item B39 Tana Paser, E. Kalimantan, Bornéo
-

- Item B40 Desa Muara Adan, Tana Paser, E. Kalimantan
- Item B41 Tana Paser, E. Kalimantan, Bornéo
- Item B42 Kutai, Kutai Kartanegara,, E. Kalimantan
- Item B43 Kutai, Kutai Kartanegara,, E. Kalimantan
- Item B44 Muara Kaman Kutai Kartanegara,, E. Kalimantan
- Item B45 Buta E. Kalimantan, Bornéo
- Item B46 Tenggarung, Kutai Kartanegara,, E. Kalimantan
- Item B47 Tenggarung, Kutai Kartanegara,, E. Kalimantan
- Item B48 troupe Tulu Paser, E. Kalimantan,
- Item B49 Sambaliung, Berau, E. Kalimantan,
- Item B50 Paser, E Kalimantan, Bornéo
- Item B51 Kutai, Guntung E. Kalimantan, Bornéo
- Item B52 Kuta, E. Kalimantan, Bornéo
-
- Item B53 Paser, E Kalimantan, Bornéo
- Item B54 Berau, E. Kalimantan, Bornéo
- Item B55 Kutai, Kutai Kartanegara,, E. Kalimantan
- Item B56 Kalimantan, Bornéo
- Item B57 Kalimantan, Bornéo
- Item B58 Kalimantan, Bornéo
- Item B59 Paser, E Kalimantan, Bornéo
- Item B60 Paser, E Kalimantan, Bornéo
- Item B61 Paser, E Kalimantan, Bornéo
- Item B62 Paser, E Kalimantan, Bornéo
- Item B63 Tenggarung, Kutai Kartanegara,, E. Kalimantan
- Item B64 Tenggarung, Kutai Kartanegara,, E. Kalimantan
- Item B65 Paser, E Kalimantan, Bornéo
- Item B66 Sangatta, E. Kalimantan, Bornéo
- Item B67 Sangatta, E. Kalimantan, Bornéo
- Item B68 Sangatta, E. Kalimantan, Bornéo
- Item B69 Sangatta, E. Kalimantan, Bornéo
- Item B70 Sangatta, E. Kalimantan, Bornéo
- Item B71 Sangatta, E. Kalimantan, Bornéo
- Item B72 Sangatta, E. Kalimantan, Bornéo
- Item B73 Kota Bangun, Kutai Kartanegara,, E. Kalimantan
- Item B74 Kutai, Kutai Kartanegara,, E. Kalimantan
- tem B75 Maker ARIFIN Tenggarung, , E. Kalimantan
- tem B76 Maker ARIFIN Tenggarung, , E. Kalimantan
- tem B77 Maker ARIFIN Tenggarung, , E. Kalimantan
- Item B78 Tenggarung, Kutai Kartanegara,, E. Kalimantan
- Item B79 Tenggarung, Kutai Kartanegara,, E. Kalimantan
- Item B80 Tenggarung, Kutai Kartanegara,, E. Kalimantan
- Item B81 Tenggarung, Kutai Kartanegara,, E. Kalimantan
- Item B82 Tenggarung, Kutai Kartanegara,, E. Kalimantan
- Item 683 Semporna, E. Sabah, Bornéo
- Item B87 Kalimantan, Bornéo
- Item B88 Mahakam river, Kutai Kartanegara,, E. Kalimantan
- Item B89 Mahakam river, Kutai Kartanegara,, E. Kalimantan
- Item B8A Maker MURAD, Kota Bangun, K; Kartanegara,, E. Kalimantan
- Item B8A Maker MURAD, Kota Bangun, k; Kartanegara,, E. Kalimantan
- Item B8B Jembayan, Kutai Kartanegara,, E. Kalimantan
- Item B8C Jembayan, Kutai Kartanegara,, E. Kalimantan
- Item B8D Maker ARIFIN Tenggarung, , E. Kalimantan
- Item B8E Maker ARIFIN Tenggarung, , E. Kalimantan
- Item B8F Maker ARIFIN Tenggarung, , E. Kalimantan
-

- Item B90 Berau, E. Kalimantan, Bornéo
- Item B91 Tana Paser, E. Kalimantan, Bornéo
- Item B92 Tana Paser, E. Kalimantan, Bornéo
- Item B93 Rizkiawan, Kutai, E. Kalimantan, Bornéo
- Item B94 Kutai, Samarinda, E. Kalimantan, Bornéo
- Item B95 E Kalimantan, Bornéo
- Item B96 Kutai, Samarinda, Kutai Kartanegara,, E. Kalimantan
- Item B97 Kutai, Samarinda, Kutai Kartanegara,, E. Kalimantan
- Item B98 Kutai, Samarinda, Kutai Kartanegara,, E. Kalimantan
- Item B99 Kutai, Samarinda, Kutai Kartanegara,, E. Kalimantan
- Item B9A Paser, E Kalimantan, Bornéo
- Item B9B Paser, E Kalimantan, Bornéo
- Item B9C Paser, E Kalimantan, Bornéo
- Item B9D Paser, E Kalimantan, Bornéo
- Item B9E Paser, E Kalimantan, Bornéo
- Item B9F Paser, E Kalimantan, Bornéo
- Item B9G Paser, E Kalimantan, Bornéo
- Item B9H Paser, E Kalimantan, Bornéo
- Item B9J Paser, E Kalimantan, Bornéo
- Item B9K Paser, E Kalimantan, Bornéo
- Item B9L Jembayan, Kutai, E. Kalimantan
- Item B9M Jembayan, Kutai, E. Kalimantan
- Item B9N Paser, E Kalimantan, Bornéo
- Item B9O Paser, E Kalimantan, Bornéo
- Item BA0 E. Kalimantan, Bornéo
- Item BA1 E. Kalimantan, Bornéo
- Item BA2 Akbar Haka, E. Kalimantan, Bornéo
- Item BA3 E. Kalimantan, Bornéo
- Item BA4 Andry WIRANATA, E. Kalimantan, Bornéo
- Item BA5 E. Kalimantan, Bornéo
- Item BA6 E. Kalimantan, Bornéo
- Item BA7 E. Kalimantan, Bornéo
- Item BA8 Kutai, E. Kalimantan, Bornéo
- Item BA9 Desa Jembayan, E. Kalimantan, Bornéo
- Item BAA Kutai, Kutai Kartanegara,, E. Kalimantan
- Item BAB Kutai, Kutai Kartanegara,, E. Kalimantan
- Item BAC Pak Om SUPYAN, Tenggarung, Kutai , E. Kalimantan
- Item BAD Pak Om SUPYAN, Tenggarung, Kutai , E. Kalimantan
- Item BAE Pak Om SUPYAN, Tenggarung, Kutai , E. Kalimantan
- Item BAF Pak Om SUPYAN, Tenggarung, Kutai , E. Kalimantan
- Item BAG E. Kalimantan, Bornéo
- Item BAH Tana Paser, E. Kalimantan, Bornéo
- Item BAI Tana Paser, E. Kalimantan, Bornéo
- Item BAJ Tana Paser, E. Kalimantan, Bornéo
- Item BAK Tana Paser, E. Kalimantan, Bornéo
-

http://inthegapbetween.free.fr/pierre/GAMBUS_PROJECT/05c PORTFOLIO part5c.pdf
http://inthegapbetween.free.fr/pierre/GAMBUS_PROJECT/05c2 PORTFOLIO part5c2.pdf
http://inthegapbetween.free.fr/pierre/GAMBUS_PROJECT/05c3 PORTFOLIO part5c3.pdf
http://inthegapbetween.free.fr/pierre/GAMBUS_PROJECT/05c4 PORTFOLIO part5c4.pdf
http://inthegapbetween.free.fr/pierre/GAMBUS_PROJECT/05c5 PORTFOLIO part5c5.pdf
http://inthegapbetween.free.fr/pierre/GAMBUS_PROJECT/05d PORTFOLIO part5d.pdf
http://inthegapbetween.free.fr/pierre/GAMBUS_PROJECT/05d2 PORTFOLIO part5d2.pdf
http://inthegapbetween.free.fr/pierre/GAMBUS_PROJECT/05d3 PORTFOLIO part5d3.pdf
http://inthegapbetween.free.fr/pierre/GAMBUS_PROJECT/05f PORTFOLIO part5f.pdf
http://inthegapbetween.free.fr/pierre/GAMBUS_PROJECT/05i PORTFOLIO part5i.pdf
http://inthegapbetween.free.fr/pierre/GAMBUS_PROJECT/05i2 PORTFOLIO part5i2.pdf
http://inthegapbetween.free.fr/pierre/GAMBUS_PROJECT/05i3 PORTFOLIO part5i3.pdf
http://inthegapbetween.free.fr/pierre/GAMBUS_PROJECT/05i4 PORTFOLIO part5i4.pdf
http://inthegapbetween.free.fr/pierre/GAMBUS_PROJECT/05i5 PORTFOLIO part5i5.pdf
http://inthegapbetween.free.fr/pierre/GAMBUS_PROJECT/05i6 PORTFOLIO part5i6.pdf
http://inthegapbetween.free.fr/pierre/GAMBUS_PROJECT/05j PORTFOLIO part5j.pdf
http://inthegapbetween.free.fr/pierre/GAMBUS_PROJECT/05t PORTFOLIO part5t.pdf
http://inthegapbetween.free.fr/pierre/GAMBUS_PROJECT/05u PORTFOLIO part5u.pdf

SOUTH KALIMANTAN

- Item C01 Banjar maker HIDAYAT, Banjar, S. Kalimantan, Bornéo
- Item C02 Banjar maker HIDAYAT, Banjar, S. Kalimantan, Bornéo
- Item C03 Banjarmasin, S. Kalimantan, Bornéo
- Item C04 Banjarmasin, S. Kalimantan, Bornéo
- Item C05 maker Bayuaji Barabai, S. Kalimantan, Bornéo
- Item C06 Banjarmasin, S. Kalimantan, Bornéo
- Item C07 maker HIDAYAT, Banjar, S. Kalimantan, Bornéo
- Item C08 maker HIDAYAT, Banjar, S. Kalimantan, Bornéo
- Item C09 maker HIDAYAT, Banjar, S. Kalimantan, Bornéo
- Item C10 maker HIDAYAT, Banjar, S. Kalimantan, Bornéo
- Item C11 maker HIDAYAT, Banjar, S. Kalimantan, Bornéo
- Item C12 Banjarmasin, S. Kalimantan, Bornéo
- Item C13 Banjarmasin, S. Kalimantan, Bornéo
- Item C14 South Kalimantan
- Item C15 Banjarmasin, S. Kalimantan, Bornéo
- Item C16 maker Alpien, Haruyan, S. Kalimantan, Bornéo
- Item C17 Segayar River, W. Kalimantan, Bornéo
- Item C18 Norman Gambus, Kotabaru, S. Kalimantan, Bornéo
- Item C19 Norman Gambus, Kotabaru, S. Kalimantan, Bornéo
- Item C20 Banjarmasin, S. Kalimantan, Bornéo
- Item C21 Banjarmasin, S. Kalimantan, Bornéo
- Item C22 Banjarmasin, S. Kalimantan, Bornéo
- Item C23 Banjarmasin, S. Kalimantan, Bornéo
- Item C24 Banjarmasin, S. Kalimantan, Bornéo
- Item C25 Banjarmasin, S. Kalimantan, Bornéo
- Item C26 Banjarmasin, S. Kalimantan, Bornéo
- Item C27 Banjarmasin, S. Kalimantan, Bornéo
- Item C28 Banjarmasin, S. Kalimantan, Bornéo
- Item C29 Banjarmasin, S. Kalimantan, Bornéo
- Item C30 maker ANWAR, Banjar, S. Kalimantan, Bornéo
- Item C31 Norman Gambus, Kotabaru, S. Kalimantan, Bornéo
- Item C32 Banjarmasin, S. Kalimantan, Bornéo
- Item C33 Banjarmasin, S. Kalimantan, Bornéo
- Item C34 Banjarmasin, S. Kalimantan, Bornéo
- Item C35 Banjarmasin, S. Kalimantan, Bornéo
- Item C36 Banjarmasin, S. Kalimantan, Bornéo
- Item C37 maker Alpien, Haruyan, S. Kalimantan, Bornéo
- Item C38 maker Alpien, Haruyan, S. Kalimantan, Bornéo
- Item C39 maker Alpien, Haruyan, S. Kalimantan, Bornéo
- Item C40 maker Alpien, Haruyan, S. Kalimantan, Bornéo
- Item C41 maker Alpien?
- Item C42 Banjarmasin, S. Kalimantan, Bornéo
- Item C43 Banjarmasin, S. Kalimantan, Bornéo
- Item C44 Banjarmasin, S. Kalimantan, Bornéo
- Item C45 Norman Gambus, Kotabaru, S. Kalimantan, Bornéo

- Item C46 souvenir Kalimantan, Bornéo
- Item C47 souvenir Kalimantan, Bornéo
- Item C48 Norman Gambus, Kotabaru, S. Kalimantan, Bornéo
- Item C49 maker BUSHAIRI, Mataraman, S. Kalimantan, Bornéo
- Item C50 maker Anwar, Banjarmasin, S. Kalimantan, Bornéo
- Item C51 maker ANUR, Banjar, S. Kalimantan, Bornéo
- Item C52 maker SYIR HAYATI, Banjar Baru, S. Kalimantan, Bornéo
- Item C53 maker ALPIAN, Haruyan, S. Kalimantan, Bornéo jar, S. Kalimantan, Bornéo
- Item C54 maker SYIR HAYATI, Banjar Baru, S. Kalimantan, Bornéo
- Item C55 Banjarmasin, S. Kalimantan, Bornéo
- Item C56 Kalimantan, Bornéo
- Item C57 Kalimantan, Bornéo
- Item C58 maker HAYATI, Banjar Baru, S. Kalimantan, Bornéo
- Item C59 Banjarmasin, S. Kalimantan, Bornéo
- Item C60 Banjarmasin, S. Kalimantan, Bornéo
- Item C61 Banjarmasin, S. Kalimantan, Bornéo
- Item C62 maker HAYATI, Banjar Baru, S. Kalimantan, Bornéo
- Item C63 Banjarmasin, S. Kalimantan, Bornéo
- Item C64 Banjarmasin, S. Kalimantan, Bornéo
- Item C65 maker HIDAYAT, Banjar, S. Kalimantan, Bornéo
- Item C66 Banjarmasin, S. Kalimantan, Bornéo
- Item C67 maker Fahrul ANWAR, Banjarmasin, S. Kalimantan, Bornéo
- Item C68 maker Syir HAYATI, Banjar Baru, S. Kalimantan, Bornéo
- Item C68 maker Syir HAYATI, Banjar Baru, S. Kalimantan, Bornéo
- Item C69 maker ANSYARI, Barikin, S. Kalimantan, Bornéo
- Item C6A maker BUSHAIRI, Mataraman, S. Kalimantan, Bornéo
- Item C6B maker BUSHAIRI, Mataraman, S. Kalimantan, Bornéo
- Item C6C maker BUSHAIRI, Mataraman, S. Kalimantan, Bornéo
- Item C6D maker BUSHAIRI, Mataraman, S. Kalimantan, Bornéo
- Item C6E maker BUSHAIRI, Mataraman, S. Kalimantan, Bornéo
- Item C6F maker BUSHAIRI, Mataraman, S. Kalimantan, Bornéo
- Item C6G maker "SIMPILANG", Panggung / Barikin, S. Kalimantan, Bornéo
- Item C6H maker "SIMPILANG", Panggung / Barikin, S. Kalimantan, Bornéo
- Item C6I maker BUSHAIRI, Mataraman, S. Kalimantan, Bornéo
- Item C6J maker BUSHAIRI, Mataraman, S. Kalimantan, Bornéo
- Item C6K maker BUSHAIRI, Mataraman, S. Kalimantan, Bornéo
- Item C6L maker BUSHAIRI, Mataraman, S. Kalimantan, Bornéo
- Item C6M maker BUSHAIRI, Mataraman, S. Kalimantan, Bornéo
- Item C6N maker BUSHAIRI, Mataraman, S. Kalimantan, Bornéo
- Item C6O Mangkau, S. Kalimantan, Bornéo
- Item C6P maker BUSHAIRI, Mataraman, S. Kalimantan, Bornéo
- Item C6Q maker BUSHAIRI, Mataraman, S. Kalimantan, Bornéo
- Item C6R maker BUSHAIRI, Mataraman, S. Kalimantan, Bornéo
- Item C6S maker BUSHAIRI, Mataraman, S. Kalimantan, Bornéo
- Item C6T maker "SIMPILANG", Panggung / Barikin, S. Kalimantan, Bornéo
- Item C6U maker "SIMPILANG", Panggung / Barikin, S. Kalimantan, Bornéo
- Item C6V maker BUSHAIRI, Mataraman, S. Kalimantan, Bornéo
- Item C6W maker BUSHAIRI, Mataraman, S. Kalimantan, Bornéo
- Item C6X maker BUSHAIRI, Mataraman, S. Kalimantan, Bornéo
-
- Item C70 Banjarmasin, S. Kalimantan, Bornéo
- Item C71 Kota Banjar, S. Kalimantan, Bornéo
- Item C72 Kota Banjar, S. Kalimantan, Bornéo
- Item C73 Kota Banjar, S. Kalimantan, Bornéo
- Item C74 maker Anwar, Banjarmasin, S. Kalimantan, Bornéo
- Item C75 maker ALPIAN, Haruyan, S. Kalimantan, Bornéo
- Item C76 maker ALPIAN, Haruyan, S. Kalimantan, Bornéo
- Item C77 Banjarmasin, S. Kalimantan, Bornéo
- Item C78 Banjarmasin, S. Kalimantan, Bornéo
- Item C79 Norman Gambus, Kotabaru, S. Kalimantan, Bornéo
- Item C7A Angkinang, S. Kalimantan, Bornéo
- Item C7B Banjarmasin, S. Kalimantan, Bornéo
- Item C7C Banjarmasin, S. Kalimantan, Bornéo
- Item C7D Banjarmasin, S. Kalimantan, Bornéo
- Item C7E maker "SIMPILANG", Panggung / Barikin, S. Kalimantan, Bornéo
- Item C7F Banjarmasin, S. Kalimantan, Bornéo

- Item C7F maker ALPIAN, Haruyan, S. Kalimantan, Bornéo
- Item C7G maker SYIR HAYATI, Banjar Baru, S. Kalimantan, Bornéo
- Item C7H maker ALPIAN, Haruyan, S. Kalimantan, Bornéo
- Item C7I maker ALPIAN, Haruyan, S. Kalimantan, Bornéo
- Item C7J maker ALPIAN, Haruyan, S. Kalimantan, Bornéo
- Item C7K maker ALPIAN, Haruyan, S. Kalimantan, Bornéo
- Item C7L maker ALPIAN, Haruyan, S. Kalimantan, Bornéo
- Item C7M maker ALPIAN, Haruyan, S. Kalimantan, Bornéo
- Item C7N maker ALPIAN, Haruyan, S. Kalimantan, Bornéo
- Item C7O maker ALPIAN, Haruyan, S. Kalimantan, Bornéo
-
- Item C80 maker Fahrul ANWAR, Banjarmasin, S. Kalimantan, Bornéo
- Item C81 maker Fahrul ANWAR, Banjarmasin, S. Kalimantan, Bornéo
- Item C82 maker ANSYARI, Barikin, S. Kalimantan, Bornéo
- Item C83 maker ANSYARI, Barikin, S. Kalimantan, Bornéo
- Item C84 maker RURUD, Barikin, S. Kalimantan, Bornéo
- Item C85 Banjarmasin, S. Kalimantan, Bornéo
- Item C86 Banjarmasin, S. Kalimantan, Bornéo
- Item C87 Kalimantan, Bornéo
- Item C88 Mahakam river, Kutai, E. Bornéo
- Item C89 Matarapura, S. Kalimantan, Bornéo
- Item C8A ANSYARI, Barikin, S. Kalimantan, Bornéo
- Item C8B maker NORMAN, Kota Baru, S. Kalimantan, Bornéo
- Item C8C Banjarmasin, S. Kalimantan, Bornéo
- Item C8D maker ANWAR, Banjar, S. Kalimantan, Bornéo
- Item C8E maker ANWAR, Banjar, S. Kalimantan, Bornéo
- Item C8F Pambanun, S. Kalimantan, Bornéo
- Item C8G Banjarmasin, S. Kalimantan, Bornéo
- Item C8H pandolin, Banjarmasin, S. Kalimantan, Bornéo
- Item C8I pandolin, Banjarmasin, S. Kalimantan, Bornéo
- Item C8J pandolin, S. Kalimantan, Bornéo
- Item C8K maker Syir HAYATI, Banjar Baru, S. Kalimantan, Bornéo
- Item C8L Kandangan, HSU, S. Kalimantan, Bornéo
- Item C8M Madang, S. Kalimantan, Bornéo
- Item C8N Tabalong, HSU, S. Kalimantan, Bornéo
- Item C8O Tabalong, HSU, S. Kalimantan, Bornéo
- Item C8P Balangan, HSU, S. Kalimantan, Bornéo
- Item C8Q Kandangan, HSU, S. Kalimantan, Bornéo
- Item C8R maker ANUR, Banjar, S. Kalimantan, Bornéo
- Item C8S pandolin, Banjarmasin, S. Kalimantan, Bornéo
- Item C8T pandolin, Banjarmasin, S. Kalimantan, Bornéo
- Item C8U Desa Srikandi, Kurau, S. Kalimantan, Bornéo
- Item C8V Desa Srikandi, Kurau, S. Kalimantan, Bornéo
- Item C8W Desa Srikandi, Kurau, S. Kalimantan, Bornéo
- Item C8X Tapin?, S. Kalimantan, Bornéo
-

SOUTH KALIMANTAN (continued)

- Item C90 maker HAYATI, Banjar Baru, S. Kalimantan,
- Item C91 maker Andre, Kota Baru, S. Kalimantan, Bornéo
- Item C92 maker HIDAYAT, Banjar, S. Kalimantan, Bornéo
- Item C93 maker ANWAR, Banjar, S. Kalimantan, Bornéo
- Item C94 maker ANUR, Banjar, S. Kalimantan, Bornéo
- Item C95 maker ANUR, Banjar, S. Kalimantan, Bornéo
- Item C96 unknown, Banjar, S. Kalimantan, Bornéo
- Item C97 unknown, Banjar, S. Kalimantan, Bornéo
- Item C98 Norman Gambus, Kotabaru, S. Kalimantan, Bornéo
- Item C99 Norman Gambus, Kotabaru, S. Kalimantan, Bornéo
- Item C9A maker Syir HAYATI, Banjar Baru, S. Kalimantan
- Item C9B maker Syir HAYATI, Banjar Baru, S. Kalimantan
- Item C9C maker Syir HAYATI, Banjar Baru, S. Kalimantan
- Item C9D maker Syir HAYATI, Banjar Baru, S. Kalimantan
- Item C9E maker Hendra CIPTA, Banjar, S. Kalimantan, Bornéo
- Item C9F maker Hendra CIPTA, Banjar, S. Kalimantan, Bornéo
- Item C9G maker HIDAYAT, Banjar, S. Kalimantan, Bornéo
- Item C9H maker HIDAYAT, Banjar, S. Kalimantan, Bornéo
- Item C9I maker HIDAYAT, Banjar, S. Kalimantan, Bornéo
- Item C9J maker HIDAYAT, Banjar, S. Kalimantan, Bornéo
- Item C9K maker HIDAYAT, Banjar, S. Kalimantan, Bornéo
- Item C9L maker Muhd HUSNI, Banjar, S. Kalimantan, Bornéo
- Item C9M maker Muhd HUSNI, Banjar, S. Kalimantan, Bornéo
- Item C9N maker Muhd HUSNI, Banjar, S. Kalimantan, Bornéo
- Item C9O maker Muhd HUSNI, Banjar, S. Kalimantan, Bornéo
- Item C9P maker Muhd HUSNI, Banjar, S. Kalimantan, Bornéo
- Item C9Q ANSYARI, Barikin, S. Kalimantan, Bornéo
- Item C9R Kandangan, S. Kalimantan, Bornéo
- Item C9S Banjarmasin, S. Kalimantan, Bornéo
- Item C9T Banjarmasin, S. Kalimantan, Bornéo
- Item C9U maker ALPIAN, Haruyan, S. Kalimantan, Bornéo jar, S.
- Item C9V maker ALPIAN, Haruyan, S. Kalimantan, Bornéo jar, S.
- Item C9W maker ALPIAN, Haruyan, S. Kalimantan, Bornéo jar, S.
- Item C9X maker ALPIAN, Haruyan, S. Kalimantan, Bornéo jar, S.
- Item C9Y maker ALPIAN, Haruyan, S. Kalimantan, Bornéo jar, S.
- Item C9Z Tapin, S. Kalimantan, Bornéo
-

- Item CA0 maker HAYATI, Banjar Baru, S. Kalimantan,
- Item CA1 Banjarmasin, S. Kalimantan, Bornéo
- Item CA2 maker HAYATI, Banjar Baru, S. Kalimantan,
- Item CA3 Banjarmasin, S. Kalimantan, Bornéo
- Item CA4 maker HAYATI, Banjar Baru, S. Kalimantan
- Item CA5 Banjarmasin, S. Kalimantan, Bornéo
- Item CA6 SYABANI, Banjarmasin, S. Kalimantan, Bornéo
- Item CA7 SYABANI, Banjarmasin, S. Kalimantan, Bornéo
- Item CA8 SYABANI, Banjarmasin, S. Kalimantan, Bornéo
- Item CA9 Norman Gambus, Kotabaru, S. Kalimantan, Bornéo
- Item CAA Norman Gambus, Kotabaru, S. Kalimantan, Bornéo
- Item CAB Norman Gambus, Kotabaru, S. Kalimantan, Bornéo
- Item CAC Norman Gambus, Kotabaru, S. Kalimantan, Bornéo
- Item CAD Norman Gambus, Kotabaru, S. Kalimantan, Bornéo
- Item CAE Norman Gambus, Kotabaru, S. Kalimantan, Bornéo
- Item CAF Banjarmasin, S. Kalimantan
- Item CAG maker HIDAYAT, Banjar, S. Kalimantan, Bornéo
- Item CAH maker Muhd HUSNI, Banjar, S. Kalimantan, Bornéo
- Item CAI maker Muhd HUSNI, Banjar, S. Kalimantan, Bornéo
- Item CAJ maker Muhd HUSNI, Banjar, S. Kalimantan, Bornéo
- Item CAK maker Muhd HUSNI, Banjar, S. Kalimantan, Bornéo
- Item CAG maker Syir HAYATI, Banjar Baru, S. Kalimantan
- Item CAH Banjarmasin, S. Kalimantan, Bornéo
- Item CAI Banjarmasin, S. Kalimantan, Bornéo
- Item CAJ maker ANWAR, Banjar, S. Kalimantan, Bornéo
- Item CAK maker Syir HAYATI, Banjar Baru, S. Kalimantan
- Item CAL maker ANUR, Banjar, S. Kalimantan, Bornéo
- Item CAM maker ANUR, Banjar, S. Kalimantan, Bornéo
- Item CAN maker Syir HAYATI, Banjar Baru, S. Kalimantan
- Item CAP Norman Gambus, Kotabaru, S. Kalimantan, Bornéo
- Item CAQ Norman Gambus, Kotabaru, S. Kalimantan, Bornéo
- Item CAR Norman Gambus, Kotabaru, S. Kalimantan, Bornéo
- Item CAS Banjarmasin, S. Kalimantan, Bornéo
- Item CAT Banjarmasin, S. Kalimantan, Bornéo
- Item CAU Banjarmasin, S. Kalimantan, Bornéo
- Item CAV Barikin, S. Kalimantan, Bornéo
- Item CAW Barikin, S. Kalimantan, Bornéo
- Item CAX Pandolin, Banjarmasin, S. Kalimantan, Bornéo
- Item CAY Pandolin, Banjarmasin, S. Kalimantan, Bornéo
- Item CAZ Pandolin, Banjarmasin, S. Kalimantan, Bornéo
-

- Item CB0 Kandangan, Banjar, S. Kalimantan, Bornéo
- Item CB1 Kandangan, Banjar, S. Kalimantan, Bornéo
- Item CB2 maker Syir HAYATI, Banjar Baru, S. Kalimantan
- Item CB3 maker Syir HAYATI, Banjar Baru, S. Kalimantan
- Item CB4 maker Syir HAYATI, Banjar Baru, S. Kalimantan
- Item CB5 maker Syir HAYATI, Banjar Baru, S. Kalimantan
- Item CB6 Banjarmasin, S. Kalimantan, Bornéo
- Item CB7 maker Syir HAYATI, Banjar Baru, S. Kalimantan
- Item CB8 Banjarmasin, S. Kalimantan, Bornéo
- Item CB9 maker Muhd HUSNI, Banjar, S. Kalimantan, Bornéo
- Item CBA maker Anwar, Banjarmasin, S. Kalimantan,
- Item CBB maker Anwar, Banjarmasin, S. Kalimantan,
- Item CBC maker Anwar, Banjarmasin, S. Kalimantan,
- Item CBD maker ZULPI, Bariikin, S. Kalimantan,
- Item CBE maker HIDAYAT, Banjar, S. Kalimantan, Bornéo
- Item C8F Norman Gambus, Kotabaru, S. Kalimantan, Bornéo
- Item C8G Norman Gambus, Kotabaru, S. Kalimantan, Bornéo
- Item CBH maker Muhd HUSNI, Banjar, S. Kalimantan, Bornéo
- Item CBI maker Muhd HUSNI, Banjar, S. Kalimantan, Bornéo
- Item CBJ maker Muhd HUSNI, Banjar, S. Kalimantan, Bornéo
- Item CBK maker Muhd HUSNI, Banjar, S. Kalimantan, Bornéo
- Item CBL Pandolin, Amuntai, S. Kalimantan, Bornéo
- Item CBM Pandolin, Amuntai, S. Kalimantan, Bornéo
- Item CBN Pandolin, Amuntai, S. Kalimantan, Bornéo
- Item CBO maker Muhd HUSNI, Banjar, S. Kalimantan,
- Item CBP maker Muhd HUSNI, Banjar, S. Kalimantan,
- Item CBQ maker Muhd HUSNI, Banjar, S. Kalimantan,
- Item CBR maker Muhd HUSNI, Banjar, S. Kalimantan,
- Item CBS maker Muhd HUSNI, Banjar, S. Kalimantan,
-

http://inthegapbetween.free.fr/pierre/GAMBUS/PROJECT/06a_PORTFOLIO_part6a.pdf
http://inthegapbetween.free.fr/pierre/GAMBUS/PROJECT/06c_PORTFOLIO_part6c.pdf
http://inthegapbetween.free.fr/pierre/GAMBUS/PROJECT/06d_PORTFOLIO_part6d.pdf
http://inthegapbetween.free.fr/pierre/GAMBUS/PROJECT/06d2_PORTFOLIO_part6d2.pdf
http://inthegapbetween.free.fr/pierre/GAMBUS/PROJECT/06d3_PORTFOLIO_part6d3.pdf
http://inthegapbetween.free.fr/pierre/GAMBUS/PROJECT/06d4_PORTFOLIO_part6d4.pdf
http://inthegapbetween.free.fr/pierre/GAMBUS/PROJECT/06e_PORTFOLIO_part6e.pdf
http://inthegapbetween.free.fr/pierre/GAMBUS/PROJECT/06e2_PORTFOLIO_part6e2.pdf
http://inthegapbetween.free.fr/pierre/GAMBUS/PROJECT/06e3_PORTFOLIO_part6e3.pdf
http://inthegapbetween.free.fr/pierre/GAMBUS/PROJECT/06f_PORTFOLIO_part6f.pdf
http://inthegapbetween.free.fr/pierre/GAMBUS/PROJECT/06f2_PORTFOLIO_part6f2.pdf
http://inthegapbetween.free.fr/pierre/GAMBUS/PROJECT/06g_PORTFOLIO_part6g.pdf
http://inthegapbetween.free.fr/pierre/GAMBUS/PROJECT/06g2_PORTFOLIO_part6g2.pdf
http://inthegapbetween.free.fr/pierre/GAMBUS/PROJECT/06h_PORTFOLIO_part6h.pdf
http://inthegapbetween.free.fr/pierre/GAMBUS/PROJECT/06h2_PORTFOLIO_part6h2.pdf
http://inthegapbetween.free.fr/pierre/GAMBUS/PROJECT/06i_PORTFOLIO_part6i.pdf
http://inthegapbetween.free.fr/pierre/GAMBUS/PROJECT/06j_PORTFOLIO_part6j.pdf
http://inthegapbetween.free.fr/pierre/GAMBUS/PROJECT/06j2_PORTFOLIO_part6j2.pdf

PART6 : LESSER SUNDA: SUMBAWA, LOMBOK (NTB)

- Item L00 anonymous, Lombok Isl, NTB
- Item L01 As Babuju, Sumbawa isl., NTB
- Item L02 Sumbawa isl, NTB
- Item L03 anonymous, Lombok Isl, NTB
- Item L04 anonymous, Lombok Isl, NTB
- Item L05 anonymous, Mataram, Lombok Isl, NTB
- Item L06 "Gambo" – Bima, Sumbawa isl., NTB
- Item L07 anonymous, Lombok Isl, NTB
- Item L08 anonymous, Lombok Isl, NTB
- Item L09 anonymous, Lombok Isl, NTB
- Item L10
- Item L11 Amat BOCONG, Lombok Isl. NTB
- Item L12 (Camden) - Lombok Isl. NTB
- Item L13 anonymous, Lombok Isl, NTB
- Item L14 anonymous, Lombok Isl, NTB
- Item L15 anonymous, Lombok Isl, NTB
- Item L16 anonymous, Lombok Isl, NTB
- Item L17 anonymous, Lombok Isl, NTB
- Item L18 anonymous, Lombok Isl, NTB
- Item L19 "Gambo" – Bima, Sumbawa isl., NTB
- Item L20 "Gambo" – Bima, Sumbawa isl., NTB
- Item L21 "Gambo" – Bima, Sumbawa isl., NTB
- Item L22 anonymous, Lombok Isl, NTB
- Item L23 anonymous, Lombok Isl, NTB
- Item L24 Tanjung, Lombok Isl. NTB
- Item L25 anonymous, Lombok Isl, NTB
- Item L26 anonymous, Lombok Isl, NTB
- Item L27 Guru ALY, Lombok Isl. NTB
- Item L28 anonymous, Lombok Isl, NTB
- Item L29 anonymous, Lombok Isl, NTB
- Item L30 Gili isl, W Lombok Isl. NTB
- Item L31 Gili isl, W Lombok Isl. NTB
- Item L32 Gili isl, W Lombok Isl. NTB
- Item L33 Gili isl, W Lombok Isl. NTB
- Item L34 Gili isl, W Lombok Isl. NTB
- Item L35 anonymous, Lombok Isl, NTB
- Item L36 anonymous, Lombok Isl, NTB
- Item L37 anonymous, Lombok Isl, NTB
- Item L38 anonymous, Lombok Isl, NTB
- Item L39 anonymous, Lombok Isl, NTB
- Item L40 "Gambo" – Bima, Sumbawa isl., NTB
- Item L41 "Gambo" – Bima, Sumbawa isl., NTB
- Item L42 Gili isl, W Lombok Isl. NTB
- Item L43 anonymous, Lombok Isl, NTB
- Item L44 E. Lombok Isl. NTB

- Item L45 anonymous, Lombok Isl, NTB
- Item L46 anonymous, Lombok Isl, NTB
- Item L47 E. Lombok Isl. NTB
- Item L48 anonymous, Lombok Isl, NTB
- Item L49 anonymous, Lombok Isl, NTB
- Item L4A anonymous, Lombok Isl, NTB
- Item L4B anonymous, Lombok Isl, NTB
- Item L50 anonymous, Lombok Isl, NTB
- Item L51 anonymous, Lombok Isl, NTB
- Item L52 anonymous, Lombok Isl, NTB
- Item L53 Yani Yan, Lombok Isl. NTB
- Item L54 Lombok Isl. NTB
- Item L55 E. Lombok Isl. NTB
- Item L56 anonymous, Lombok Isl, NTB
- Item L57 A.Wahab, "Gambo" – Bima, Sumbawa isl., NTB
- Item L58 "Gambo" – Bima, Sumbawa isl., NTB
- Item L59 anonymous, Lombok Isl, NTB
- Item L60 anonymous, Lombok Isl, NTB
- Item L61 anonymous, Lombok Isl, NTB
- Item L62 anonymous, Lombok Isl, NTB
- Item L63 anonymous, Lombok Isl, NTB
- Item L64 anonymous, Lombok Isl, NTB
- Item L65 anonymous, Lombok Isl, NTB
- Item L66 anonymous, Lombok Isl, NTB
- Item L67 anonymous, Lombok Isl, NTB
- Item L68 "Gambo" – Bima, Sumbawa isl., NTB
- Item L69 anonymous, Lombok Isl, NTB
- Item L6A "Gambo" – Bima, Sumbawa isl., NTB
- Item L6B "Gambo" – Bima, Sumbawa isl., NTB
- Item L6C "Gambo" – Bima, Sumbawa isl., NTB
- Item L6D "Gambo" – Bima, Sumbawa isl., NTB
- Item L6E anonymous, Lombok Isl, NTB
- Item L6F anonymous, Lombok Isl, NTB
- Item L6G anonymous, Lombok Isl, NTB
- Item L6H anonymous, Lombok Isl, NTB
- Item L6J anonymous, Lombok Isl, NTB
- Item L6K anonymous, Lombok Isl, NTB
- Item L6L anonymous, Lombok Isl, NTB
- Item L6M anonymous, Lombok Isl, NTB
- Item L6N anonymous, Lombok Isl, NTB
- Item L6O anonymous, Lombok Isl, NTB
- Item L6P anonymous, Lombok Isl, NTB
- Item L6Q anonymous, Lombok Isl, NTB
- Item L6R anonymous, Lombok Isl, NTB
- Item L6S anonymous, Lombok Isl, NTB
- Item L6T "Gambo" – Bima, Sumbawa isl., NTB
- Item L6U "Gambo" – Dompu, Sumbawa isl., NTB
- Item L6V anonymous, Lombok Isl, NTB
- Item L6W anonymous, Lombok Isl, NTB
- Item L6X anonymous, Lombok Isl, NTB
- Item L6Y anonymous, Lombok Isl, NTB
- Item L6Z anonymous, Lombok Isl, NTB
- Item L70 anonymous, Lombok Isl, NTB
- Item L71 anonymous, Lombok Isl, NTB
- Item L72 anonymous, Lombok Isl, NTB
- Item L73 Mataram market, Lombok isl., NTB
- Item L74 "Gambo" – Bima, Sumbawa isl., NTB
- Item L75 "Gambo" – Bima, Sumbawa isl., NTB
- Item L76 "Gambo" – Daha, Bima, NTB
- Item L77 Ustd Sawal, Lombok Isl., NTB
- Item L78 Ustd Afendi, Lombok Isl., NTB
- Item L79 Ustd Afendi, Lombok Isl., NTB
- Item L80 anonymous, Lombok (MRAH museum, BE)
- Item L81 anonymous, Lombok Isl, NTB
- Item L82 anonymous, Lombok (MRAH museum, BE)
- Item L83 anonymous, Lombok Isl, NTB
- Item L84 anonymous, Lombok Isl, NTB
- Item L85 Mataram museum, Lombok Isl, NTB
- Item L86 anonymous, Lombok Isl, NTB

- Item L87 ebay, Lombok Isl, NTB
- Item L88 anonymous, Lombok Isl, NTB
- Item L89 anonymous, Lombok Isl, NTB
- Item L90 ebay, Lombok Isl, NTB
- Item L91 (Mr Sondheim), Lombok Isl, NTB
- Item L92 ebay, Lombok Isl, NTB
- Item L93 ebay, Lombok Isl, NTB
- Item L94 anonymous, Lombok Isl, NTB
- Item L95 anonymous, Lombok Isl, NTB
- Item L96 anonymous, Lombok Isl, NTB
- Item L97 anonymous, Lombok Isl, NTB
- Item L98 anonymous, Lombok Isl, NTB
- Item L99 anonymous, Lombok Isl, NTB
- Item L9A anonymous, Lombok Isl, NTB
- Item L9B anonymous, Lombok Isl, NTB
- Item L9C anonymous, Lombok Isl, NTB
- Item L9D anonymous, Lombok Isl, NTB
- Item L9E "Gambo" – Bima, Sumbawa isl., NTB
- Item L9F anonymous, Lombok Isl, NTB
- Item L9G anonymous, Lombok Isl, NTB
- Item L9H anonymous, Lombok Isl, NTB
- Item L9I anonymous, Lombok Isl, NTB
- Item L9J boat lute, Lombok Isl, NTB
- Item L9K Lombok Isl, NTB
- Item L9L Desa Sapit, Lombok Isl, NTB
- Item L9M "Gambo" – Bima, Sumbawa isl., NTB
- Item L9N "Gambo" – Bima, Sumbawa isl., NTB
- Item L9O anonymous, Lombok Isl, NTB
- Item L9P anonymous, Lombok Isl, NTB
- Item L9Q anonymous, Lombok Isl, NTB
- Item L9R anonymous, Lombok Isl, NTB
- Item L9S "Gambo" – Bima, Sumbawa isl., NTB
- Item L9T anonymous, Lombok Isl, NTB
- Item L9U anonymous, Lombok Isl, NTB
- Item L9V anonymous, Lombok Isl, NTB
- Item L9W anonymous, Lombok Isl, NTB
- Item L9X anonymous, Lombok Isl, NTB
- Item L9Y anonymous, Lombok Isl, NTB
- Item L9Z anonymous, Lombok Isl, NTB
- Item LA0 anonymous, Lombok Isl, NTB
- Item LA1 anonymous, Lombok Isl, NTB
- Item LA2 anonymous, Lombok Isl, NTB
- Item LA3 Ampenan, Lombok Isl. NTB
- Item LA4 anonymous, Lombok Isl, NTB
- Item LA5 anonymous, Lombok Isl, NTB
- Item LA6 anonymous, Lombok Isl, NTB
- Item LA7 Ampenan, Lombok Isl. NTB
- Item LA8 anonymous, Lombok Isl, NTB
- Item LA9 anonymous, Lombok Isl, NTB
- Item LB0 anonymous, Lombok Isl, NTB
- Item LB1 anonymous, Lombok Isl, NTB
- Item LB2 anonymous, Lombok Isl, NTB
- Item LB3 anonymous, Lombok Isl, NTB
- Item LB4 anonymous, Lombok Isl, NTB
- Item LB5 anonymous, Lombok Isl, NTB
- Item LB6 anonymous, Lombok Isl, NTB
- Item LB7 anonymous, Lombok Isl, NTB
- Item LB8 anonymous, SW Lombok Isl, NTB
- Item LB9 anonymous, Lombok Isl, NTB
- Item LBA anonymous, Lombok Isl, NTB
- Item LBB anonymous, Lombok Isl, NTB
- Item LBC w. Kemur Jali, Desa Beleka,C. Lombok Isl,
- Item LBD anonymous, Lombok Isl, NTB
- Item LBE anonymous, Lombok Isl, NTB
- Item LBF anonymous, Lombok Isl, NTB
- Item LBG anonymous, Lombok Isl, NTB
- Item LBH anonymous, Lombok Isl, NTB
- Item LBI anonymous, Lombok Isl, NTB
- Item LBJ w. Kemur Jali, Desa Beleka,C. Lombok Isl,
- Item LBK w. Kemur Jali, Desa Beleka,C. Lombok Isl,
- Item LBL w. Kemur Jali, Desa Beleka,C. Lombok Isl,
- Item LBM w. Kemur Jali, Desa Beleka,C. Lombok Isl,

- Item LBN anonymous, Lombok Isl, NTB
- Item LBO anonymous, Lombok Isl, NTB
- Item LBP anonymous, Lombok Isl, NTB
- Item LBQ anonymous, Lombok Isl, NTB
- Item LBR anonymous, Lombok Isl, NTB
- Item LBS anonymous, Lombok Isl, NTB
- Item LBT anonymous, Lombok Isl, NTB
- Item LBU w. Kemur Jali, Desa Beleka,C. Lombok Isl,
-

http://intheapbetween.free.fr/pierre/GAMBUS_PROJECT/07a_PORTFOLIO_part7a.pc
http://intheapbetween.free.fr/pierre/GAMBUS_PROJECT/07b_PORTFOLIO_part7b.pc
http://intheapbetween.free.fr/pierre/GAMBUS_PROJECT/07c_PORTFOLIO_part7c.pc
http://intheapbetween.free.fr/pierre/GAMBUS_PROJECT/07d_PORTFOLIO_part7d.pc
http://intheapbetween.free.fr/pierre/GAMBUS_PROJECT/07e_PORTFOLIO_part7e.pc
http://intheapbetween.free.fr/pierre/GAMBUS_PROJECT/07g_PORTFOLIO_part7g.pc
http://intheapbetween.free.fr/pierre/GAMBUS_PROJECT/07h_PORTFOLIO_part7h.pc

PART7 : FLORES (NTT)

- Item U01 ano, Alor Isl, E. Flores, NTT (Indonesia)
- Item U02 Lamlohot isl, E. Flores, NTT (Indonesia)
- Item U03 Lamlohot isl, E. Flores, NTT (Indonesia)
- Item U04 Alor isl, E. Flores, NTT (Indonesia)
- Item U05 Solor isl, E. Flores, NTT (Indonesia)
- Item U06 Adonara isl, E. Flores, NTT (Indonesia)
- Item U07 Alor isl, E. Flores, NTT (Indonesia)
- Item U08 Adonara isl, E. Flores, NTT (Indonesia)
- Item U09 Lamalaha, E. Flores, NTT (Indonesia)
- Item U10 E. Flores, NTT (Indonesia)
- Item U11 Flores, NTT (Indonesia)
- Item U12 Sikka, W. Flores, NTT (Indonesia)
- Item U13 TBD in. Flores, NTT (Indonesia)
- Item U14 Kangge isl, Alor isl, E. Flores, NTT (Indonesia)
- Item U15 Maumere, Flores, NTT (Indonesia)
- Item U16 Solor isl, E. Flores, NTT (Indonesia)
- Item U17 W. Adonara isl, E. Flores, NTT (Indonesia)
- Item U18 Wulandoni, Lembata Isl, E. Flores, NTT
- Item U19 Ende, Flores, NTT (Indonesia)
- Item U20 Pulau Boleng, E. Flores, NTT (Indonesia)
- Item U21 Adonara isl, E. Flores, NTT (Indonesia)
- Item U22 Adonara isl, E. Flores, NTT (Indonesia)
- Item U23 Tenau, Timor, NTT
- Item U24 Adonara isl, E. Flores, NTT (Indonesia)
- Item U25 Lamakera, Solor Isl, E. Flores, NTT,
- Item U26 Kedang, Lembata Isl, E. Flores, NTT,
- Item U27 Adonara isl, E. Flores, NTT (Indonesia)
- Item U28 Lamakera, Solor isl, E. Flores, NTT (Indonesia)
- Item U29 Lamakera, Solor isl, E. Flores, NTT (Indonesia)
- Item U30 Kangge isl, Alor isl, E. Flores, NTT (Indonesia)
- Item U31 Lembata, E. Flores, NTT,
- Item U32 Lembata, E. Flores, NTT,
- Item U33 Lio tribesmen, Flores, NTT,
- Item U34 Sikka tribesmen, Flores, NTT,
- Item U35 Timor, NTT
- Item U36 Timor, NTT
- Item U37 Misool isl, Papua province
- Item U38 Manggarai, W. Flores, NTT (Indonesia)
- Item U39 Lamakera, Solor, E. Flores, NTT,
- Item U40 Adonara, E. Flores, NTT,
- Item U41 Manggarai, W. Flores, NTT (Indonesia)
- Item U42 Rudin, Alor Isl, E. Flores, NTT (Indonesia)
- Item U43 Raymunde MITTE, Ende, Flores, NTT,
- Item U44 Lio people, Ende, Flores, NTT,
- Item U45 Lembata Isl, E. Flores, NTT,
- Item U46 Bugis, Ende, Flores, NTT,
- Item U47 Sikka, Flores, NTT,

- Item U48 Labuan Bajo, SW Flores, NTT
- Item U49 disambiguation **Bijol / Boko** in Flores
- Item U50 NTT,
- Item U51 Sorong, West Papua
- Item U52 Syarat Libana, Tinale, Alor, Flores,
- Item U53 Ende, Flores, NTT,
- Item U54 Ende?, Flores, NTT,
- Item U55 Lamaleha, E. Flores, NTT,
- Item U56 Adonara, E. Flores, NTT,
- Item U57 Indonesia (Vancouver museum).
- Item U58 Lamalohot, E. Flores, NTT,
- Item U59 Alor, E. Flores, NTT (Indonesia Heritage.org)
- Item U5A Timor, NTT
- Item U5B Timor, NTT
- Item U5C Maumere, Flores, NTT,
- Item U5D Maumere, Flores, NTT,
- Item U5E Manggarai, W. Flores, NTT,
- Item U5F Manggarai, W. Flores, NTT,
- Item U5G Manggarai, W. Flores, NTT,
- Item U5H Alor, E. Flores, NTT,
- Item U5I Alor, E. Flores, NTT,
- Item U5J Adonara, E. Flores, NTT,
-
- Item U60 Sudin, Adonara, E. Flores, NTT,
- Item U61 Lembata, E. Flores, NTT,
- Item U62 Lembata?, E. Flores, NTT,
- Item U63 Alor museum, E. Flores, NTT (Indonesia)
- Item U64 SW Manggarai, Flores, NTT (Indonesia)
- Item U65 Flores, NTT,
- Item U66 disambiguation Maumere, Flores (Indonesia)
- Item U67 disambiguation Maumere, Flores (Indonesia)
- Item U68 Maumere, Flores, NTT,
- Item U69 Maumere, Flores, NTT,
- Item U70 Maumere, Flores, NTT,
- Item U71 Lembata?, E. Flores, NTT,
- Item U72 Lamalohot, E. Flores, NTT
- Item U73 Solor Isl, E. Flores, NTT,
- Item U74 disambiguation **Juke lele** in Papua
- Item U75 Ende, Flores, NTT ?,
- Item U76 East Flores, NTT
- Item U77 Flores, NTT,
- Item U78 Waiverang, E. Flores, NTT,
- Item U79 Pulau Longos, Ende, E. Flores, NTT,
- Item U80 Lembata, E. Flores, NTT,
- Item U81 Flores, NTT,
- Item U82 Flores, NTT,
- Item U83 Flores, NTT,
- Item U84 Lamaleha, E. Flores, NTT,
- Item U85 SW Manggarai, Flores, NTT (Indonesia)
- Item U86 Timur, NTT (Indonesia)
- Item U87 Jayapura, West Papua, (Indonesia)
- Item U88 Alor, E. Flores, NTT (Indonesia)
- Item U89 Adonara, E. Flores, NTT,
- Item U8A Pulau Buaya, Alor, E. Flores, NTT,
- Item U8B Boleng /Adonara, E. Flores, NTT,
- Item U8C Lembata, E. Flores, NTT,
- Item U8D Sikka regency, Flores, NTT,
- Item U8E Maumere, Flores, NTT,
- Item U8F Solor, Flores, NTT,
- Item U8G Labuan Bajo, Flores, NTT,
- Item U8H Solor, Flores, NTT,
- Item U8I Maumere, Flores, NTT,
- Item U8J Wolomapa, Sikka regency, Flores, NTT,
- Item U8K Lembata Isl, E. Flores, NTT,
- Item U8L Ende, Flores, NTT,
- Item U8M Ende, Flores, NTT,
- Item U8M Adonara, E. Flores, NTT,
- Item UBO ano, Alor Isl, E. Flores, NTT (Indonesia)

- Item U90 Maumere, Flores, NTT,
- Item U91 Konda, Papua
- Item U92 Maumere, Flores, NTT,
- Item U93 Manggarai, W. Flores, NTT (Indonesia)
- Item U94 Alor, E. Flores, NTT (Indonesia)
- Item U95 Ende, Flores, NTT,
- Item U96 Flores, NTT,
- Item U97 Adonara, E. Flores, NTT,
- Item U98 Manggarai, W. Flores, NTT (Indonesia)
- Item U99 Manggarai, W. Flores, NTT (Indonesia)
- Item U9A Adonara, E. Flores, NTT,
- Item U9B Manggarai, W. Flores, NTT (Indonesia)
- Item U9C Maumere, Flores, NTT (Indonesia)
- Item U9D Maumere, Flores, NTT (Indonesia)
- Item U9E Maumere, Flores, NTT (Indonesia)
- Item U9F disambiguation Maumere, Flores (Indonesia)
- Item U9G disambiguation Maumere, Flores (Indonesia)
- Item U9H Maumere, Flores, NTT (Indonesia)
- Item U9I Maumere, Flores, NTT (Indonesia)
- Item U9J disambiguation Maumere, Flores (Indonesia)
- Item U9K disambiguation Maumere, Flores (Indonesia)
- Item U9L Maumere, Flores, NTT (Indonesia)
- Item U9M Alor, E. Flores, NTT,
- Item U9N Lembata, E. Flores, NTT,
- Item U9N Adonara, E. Flores, NTT,

PART8k : MALUKU / MOLUCCAS

- Item Q00 disambiguation Jukulele Moluccas
- Item Q05 Tanimbar, Moluccas arch..
-
- Item Q07 Tanimbar, Moluccas arch..
- Item Q10 Suru, Seram Isl, Moluccas
- Item Q18 Yamdena, Moluccas arch..
- Item Q19 Tanimbar, Moluccas arch..
- Item Q20 Tanimbar, Moluccas arch..
- Item Q21 Tanimbar, Moluccas arch..
- Item Q22 Halmahera, Moluccas arch..
- Item Q23 Halmahera, Moluccas arch..
- Item Q24 Halmahera, Moluccas arch..
- Item Q25 Tidore, Moluccas arch.
- Item Q26 Tidore, Moluccas arch.
-
- Item Q33 Tidore, Moluccas arch.
- Item Q34 Moluccas arch.
- Item Q35 Moluccas arch.
- Item Q36 Kei Isl, Moluccas arch.
- Item Q37 Kei Isl, Moluccas arch.
- Item Q38 Buru Isl, Moluccas arch.
-
-
- Item Q45 S. Moluccas
- Item Q46 Kei Isl, Moluccas
-
-
- Item Q83 Seram isl, Moluccas arch.
- Item Q84 Sula Isl, Moluccas
- Item Q85 Moluccas
- Item Q86 Sanana Isl, Sula arch., North Moluccas
-
-
- Item Q95 Kur isl, Moluccas arch.
- Item Q96 Aru isl, Moluccas arch.
-
-

http://inthe-gap-between.free.fr/pierre/GAMBUS_PROJECT/08a_PORTFOLIO_part8a.pdf
http://inthe-gap-between.free.fr/pierre/GAMBUS_PROJECT/08c_PORTFOLIO_part8c.pdf
http://inthe-gap-between.free.fr/pierre/GAMBUS_PROJECT/08c2_PORTFOLIO_part8c2.pdf
http://inthe-gap-between.free.fr/pierre/GAMBUS_PROJECT/08c3_PORTFOLIO_part8c3.pdf
http://inthe-gap-between.free.fr/pierre/GAMBUS_PROJECT/08c4_PORTFOLIO_part8c4.pdf
http://inthe-gap-between.free.fr/pierre/GAMBUS_PROJECT/08d_PORTFOLIO_part8d.pdf
http://inthe-gap-between.free.fr/pierre/GAMBUS_PROJECT/08d2_PORTFOLIO_part8d2.pdf
http://inthe-gap-between.free.fr/pierre/GAMBUS_PROJECT/08e_PORTFOLIO_part8e.pdf
http://inthe-gap-between.free.fr/pierre/GAMBUS_PROJECT/08e2_PORTFOLIO_part8e2.pdf
http://inthe-gap-between.free.fr/pierre/GAMBUS_PROJECT/08g_PORTFOLIO_part8g.pdf
http://inthe-gap-between.free.fr/pierre/GAMBUS_PROJECT/08h_PORTFOLIO_part8h.pdf
http://inthe-gap-between.free.fr/pierre/GAMBUS_PROJECT/08i_PORTFOLIO_part8i.pdf
http://inthe-gap-between.free.fr/pierre/GAMBUS_PROJECT/08j_PORTFOLIO_part8j.pdf
http://inthe-gap-between.free.fr/pierre/GAMBUS_PROJECT/08k_PORTFOLIO_part8k.pdf

PART8a : S.SULAWESI

- Item 800 Makassar, south Sulawesi
- Item 801 Makassar, south Sulawesi
- Item 802 Makassar, south Sulawesi
- Item 803 Soppeng, south Sulawesi
- Item 804 Makassar, south Sulawesi
- Item 805
- Item 806 Selayar Arch., S Sulawesi
- Item 807 Selayar Arch., S Sulawesi
- Item 808 Tompo, S Sulawesi Item
- Item 809 Buton Isl, S-E Sulawesi isl.
- Item 80A Makassar, south Sulawesi
- Item 80B Makassar, south Sulawesi
- Item 80C Turatea, south Sulawesi
- Item 80D Takalar, south Sulawesi
- Item 80E Sicini, Gowa, south Sulawesi
-
- Item 810 Muna, S-E Sulawesi isl.
- Item 811 Muna, S-E Sulawesi isl.
- Item 812 Buton Isl, S-E Sulawesi isl.
- Item 813 Muna, S-E Sulawesi isl.
- Item 814 Muna, S-E Sulawesi isl.
- Item 815 Makassar, south Sulawesi Isl.
- Item 816 Wakatobi, SE Sulawesi Isl
- Item 817 Wakatobi, SE Sulawesi Isl
- Item 818 Kendari, SE Sulawesi Isl
- Item 819 Kendari, SE Sulawesi Isl
- Item 820 Kendari, SE Sulawesi Isl
- Item 821 Utara Bombang, south Sulawesi Isl.
- Item 822 Selayar Arch., south Sulawesi Isl
- Item 823 Muna, SE Sulawesi Isl
- Item 824 Selayar Arch., south Sulawesi Isl
- Item 825 Makassar, south Sulawesi Isl.
- Item 826 Bugis, Sulawesi Isl.
- Item 827 Gowa, south Sulawesi Isl.
- Item 828 Gowa, south Sulawesi Isl.
- Item 829 Makassar, south Sulawesi Isl.
- Item 830 Makassar, south Sulawesi Isl.
- Item 831 Muna Isl, SE Sulawesi Isl.
- Item 832 Maros, south Sulawesi
- Item 833 Muna Isl, SE Sulawesi Isl.
- Item 834 Maros, south Sulawesi
- Item 835 Makassar, south Sulawesi
- Item 836 Makassar, south Sulawesi
- Item 837 south Sulawesi
- Item 838 Muna, S-E Sulawesi isl.
- Item 839 Muna, S-E Sulawesi isl.
-

- Item 840 Muna, S-E Sulawesi Item
- Item 841 south Sulawesi
- Item 842 Makassar ?, south Sulawesi
- Item 843 Muna, S-E Sulawesi isl.
- Item 844 unknown Bugis, SuSel
- Item 845 Konawe, "eastern" SuSel
- Item 846 Muna, S-E Sulawesi isl.
- Item 847 Selayar, south Sulawesi
- Item 848 Warkop, Selayar arch, south Sulawesi Isl.
- Item 849 Makassar, south Sulawesi Isl.
- Item 850 Selayar, south Sulawesi
- Item 851 Wakantolalo, south Sulawesi
- Item 852 Badjao, Celebes sea
- Item 853 Pare-Pare, south Sulawesi Isl
- Item 854 Selayar, south Sulawesi
- Item 855 Selayar, south Sulawesi
- Item 856 Selayar, south Sulawesi
- Item 857 Jenepon, south Sulawesi
- Item 858 Gowa, south Sulawesi
- Item 859 Makassar, south Sulawesi
- Item 860 Maros, south Sulawesi Isl
- Item 861 Jenepon?, south Sulawesi
- Item 862 Muna, S-E Sulawesi isl.
- Item 863 Pangkep, south Sulawesi Isl.
- Item 864 Muna, S-E Sulawesi isl.
- Item 865 Bantorea, south Sulawesi Isl.
- Item 866 Sulawesi Isl
- Item 868 Pangkep, south Sulawesi Isl.
- Item 869 Makassar, south Sulawesi Isl.
- Item 870 Mangkutana, Luwu , East Sulawesi Isl.
- Item 871 Buton Isl, S-East Sulawesi Isl.
- Item 872 Makassar,? Sulawesi Isl
- Item 873 Pare-Pare, south Sulawesi Isl
- Item 874 Makassar, south Sulawesi Isl
- Item 875 Makassar, south Sulawesi Isl
- Item 876 Makassar, south Sulawesi Isl
- Item 877 Makassar, south Sulawesi Isl
- Item 878 Makassar, south Sulawesi Isl
- Item 879 Kota Kendari, SE Sulawesi Isl
- Item 880 Wakatobi, SE Sulawesi Isl
- Item 881 Gowa?, south Sulawesi Isl
- Item 882 Selayar, south Sulawesi
- Item 883 Makassar, south Sulawesi Isl
- Item 884 Pangkep, south Sulawesi Isl
- Item 885 Makassar, south Sulawesi Isl
- Item 886 Makassar, south Sulawesi Isl
- Item 887 Makassar, south Sulawesi Isl
- Item 888 Makassar, south Sulawesi Isl
- Item 889 Gowa, south Sulawesi Isl
- Item 890 Gowa, south Sulawesi Isl
- Item 891 Makassar?, south Sulawesi Isl
- Item 892 Muna?, S-E Sulawesi isl.
- Item 893 Muna, SE Sulawesi Isl
- Item 894 Buton?, S-E Sulawesi isl.
- Item 895 Muna, SE Sulawesi Isl
- Item 896 Makassar?, south Sulawesi Isl
- Item 897 Buton Isl, SE Sulawesi Isl
- Item 898 Sanrobengi Isl, W Sulawesi Isl
- Item 899 South Sulawesi, Selayar?
- Item 900 Makassar, south Sulawesi Isl
- Item 901 Muna, S-E Sulawesi isl.
- Item 902 Makassar, south Sulawesi Isl
- Item 903 Bantoeng, south Sulawesi Isl
- Item 904 Bantoeng, south Sulawesi Isl
- Item 905 Makassar, south Sulawesi Isl
- Item 906 Turatea, south Sulawesi Isl
- Item 907 Makassar, Sulawesi Isl
- Item 908 Tolaki tribesmen, SE Sulawesi Isl

- Item 909 Kota Kendari, SE Sulawesi Isl
- Item 910 Makassar, south Sulawesi Isl.
- Item 911 Selayar Arch., south Sulawesi Isl
- Item 912 Bullu Tellue, south Sulawesi Isl
- Item 913 Makassar, south Sulawesi Isl.
- Item 914 Muna Isl, SE Sulawesi Isl.
- Item 915 Bone, East Sulawesi Isl.
- Item 916 Makassar, Sulawesi Isl.
- Item 917 Makassar, Sulawesi Isl.
- Item 918 Makassar?, Sulawesi Isl.
- Item 919 Makassar, Sulawesi Isl.
- Item 920 Selayar Arch., south Sulawesi Isl
- Item 921 Selayar Arch., south Sulawesi Isl
- Item 922 Makassar, south Sulawesi Isl.
- Item 923 Buton Isl, south Sulawesi Isl.
- Item 924 Muna Isl, south Sulawesi Isl.
- Item 925 Sinjai, Makassar, south Sulawesi Isl
- Item 926 Bantimurung, south Sulawesi Isl
- Item 927 Gowa, south Sulawesi
- Item 928 Muna Isl, SE Sulawesi Isl.
- Item 929 Banggai Isl (museum), SE Sulawesi Isl.
- Item 930 Muna Isl, SE Sulawesi Isl.
- Item 931 Selayar Arch., south Sulawesi Isl
- Item 932 Selayar Arch., south Sulawesi Isl
- Item 933 Muna Isl, SE Sulawesi Isl.
- Item 934 Gowa, south Sulawesi Isl
- Item 935 Sinjai Borong, south Sulawesi Isl
- Item 936 Muna Isl, SE Sulawesi Isl.
- Item 937 Muna Isl, SE Sulawesi Isl.
- Item 938 Kedari, Sulawesi Isl.
- Item 939 Buton, S-E Sulawesi isl.
- Item 940 Makassar, south Sulawesi Isl
- Item 941 Bulukumba, S Sulawesi Isl.
- Item 942 Makassar, Sulawesi Isl.
- Item 943 Poso, Sulawesi Isl.
- Item 944 Bantaeng, S. Sulawesi Isl.
- Item 945 Sinjai, south Sulawesi Isl
- Item 946 Pakue Tengah, E Sulawesi Isl
- Item 947 Pangkep, south Sulawesi Isl.
- Item 948 Wakatobi, SE Sulawesi Isl.
- Item 949 ustad Ajiju, Wakatobi, SE Sulawesi Isl.
- Item 949 Lamata, south Sulawesi Isl.
- Item 950 Makassar, south Sulawesi Isl
- Item 951 Bira, south Sulawesi Isl
- Item 952 Jennepono, south Sulawesi Isl
- Item 953 South Sulawesi Isl
- Item 954 Buton, S-E Sulawesi isl.
- Item 955 Makassar, south Sulawesi Isl
- Item 956 Selayar Arch., south Sulawesi Isl
- Item 957 Makassar, south Sulawesi Isl
- Item 958 Makassar, south Sulawesi Isl
- Item 959 Gowa, south Sulawesi Isl
- Item 960 South Sulawesi Isl
- Item 961 South Sulawesi Isl
- Item 962 Jennepono, south Sulawesi Isl
- Item 963 Jennepono, south Sulawesi Isl
- Item 964 Jennepono, south Sulawesi Isl
- Item 965 Makassar, south Sulawesi
- Item 966 Ridwan / Bugis., Sulawesi
- Item 967 Mamuju., Central Sulawesi
- Item 968 Bugis, central Sulawesi
- Item 969 Muna Isl, SE Sulawesi Isl.
- Item 970 Wakatobi, SE Sulawesi Isl

- Item 971 Wakatobi, SE Sulawesi Isl
- Item 972 Pulau Manuii, Sulawesi central
- Item 973 Wakatobi, SE Sulawesi Isl
- Item 974 Wakatobi, SE Sulawesi Isl
- Item 975 Wakatobi, SE Sulawesi Isl
- Item 976 Gunung Jaya, Buton, S-E Sulawesi isl.
- Item 977 Buton, S-E Sulawesi isl.
- Item 978 Gowa?, south Sulawesi Isl
- Item 979 Gowa?, south Sulawesi Isl
- Item 980 Gorontalo, N. Sulawesi Isl
- Item 981 Soppeng, south Sulawesi Isl
- Item 982 Konawe, SE Sulawesi Isl
- Item 983 Makassar, south Sulawesi
- Item 984 Buton, S-E Sulawesi isl.
- Item 985 Buton, S-E Sulawesi isl.
- Item 986 Buton, S-E Sulawesi isl.
- Item 987 Buton, S-E Sulawesi isl.
- Item 988 Pulau Manui, S-E Sulawesi isl.
- Item 989 Muna., S-E Sulawesi isl.
- Item 990 Buton, S-E Sulawesi isl.
- Item 991 Buton, S-E Sulawesi isl.
- Item 992 Konawe, SE Sulawesi Isl
- Item 993 Makassar, south Sulawesi
- Item 994 Wakatobi, SE Sulawesi Isl.
- Item 995 Aru isl, Moluccas arch.
- Item 996 Maros, central Sulawesi
- Item 997 south Sulawesi Isl
- Item 998 Sinjai, south Sulawesi
- Item 999 Tibojong, south Sulawesi
- Item 99A Buton, S-E Sulawesi isl.
- Item 99B Buton, S-E Sulawesi isl.
- Item 99C Muna., S-E Sulawesi isl.
- Item 99D Muna., S-E Sulawesi isl.
- Item 99E Muna., S-E Sulawesi isl.
- Item 99F Muna., S-E Sulawesi isl.
- Item 99G Buton, S-E Sulawesi isl.
- Item 99H Buton, S-E Sulawesi isl.
- Item 99I Sinjai, S. Sulawesi isl.
- Item 99J N. Buton, S-E Sulawesi isl.
- Item 99K Pulau Kuduatua, Muna., Sulawesi isl.
- Item 99L Desa Mata Oleo, Kendari, SE Sulawesi Isl
- Item 99M Kendari, SE Sulawesi Isl
- Item 99N Konawe, SE Sulawesi Isl
-

http://intheqapbetween.free.fr/pierre/GAMBUS_PROJECT/08b_PORTFOLIO_part8b.pd
http://intheqapbetween.free.fr/pierre/GAMBUS_PROJECT/08b2_PORTFOLIO_part8b2
http://intheqapbetween.free.fr/pierre/GAMBUS_PROJECT/08f_PORTFOLIO_part8f.pd

PART8b,f : N.SULAWESI

- Item W01 Gorontalo, N Sulawesi Isl
- Item W02 Mongondow, Kotamobagu, N Sulawesi Isl
- Item W03 Mongondow, Kotamobagu, N Sulawesi Isl
- Item W04 Mongondow, Kotamobagu, N Sulawesi Isl
- Item W05 Mongondow, Kotamobagu, N Sulawesi Isl
- Item W06 Mongondow, Kotamobagu, N Sulawesi Isl
- Item W07 Mongondow, Kotamobagu, N Sulawesi Isl
- Item W08 Mongondow, Kotamobagu, N Sulawesi Isl
- Item W09 Mongondow, Kotamobagu, N Sulawesi Isl
- Item W10 Mongondow, Kotamobagu, N Sulawesi Isl
- Item W11 Mongondow, Kotamobagu, N Sulawesi Isl
- Item W12 Gorontalo, N Sulawesi Isl
- Item W13 Gorontalo, N Sulawesi Isl
- Item W14 Gorontalo, N Sulawesi Isl
- Item W15 Gorontalo, N Sulawesi Isl
- Item W16 Gorontalo, N Sulawesi Isl
- Item W17 Gorontalo, N Sulawesi Isl
- Item W18 Manado/ Mingondow, N Sulawesi Isl
- Item W19 Gorontalo, N Sulawesi Isl
- Item W20 Gorontalo, N Sulawesi Isl
- Item W21 Gorontalo, N Sulawesi Isl
- Item W22 Pulau Sanghie, N Sulawesi Isl
- Item W23 Gorontalo, N Sulawesi Isl
- Item W24 Gorontalo, N Sulawesi Isl
- Item W25 Gorontalo, N Sulawesi Isl
- Item W26 Gorontalo, N Sulawesi Isl
-
- Item W40 Gorontalo, N Sulawesi Isl
- Item W41 Gorontalo, N Sulawesi Isl
- Item W42 Gorontalo, N Sulawesi Isl
- Item W43 Gorontalo, N Sulawesi Isl
- Item W44 Gorontalo, N Sulawesi Isl
- Item W45 Gorontalo, N Sulawesi Isl
- Item W46 Gorontalo, N Sulawesi Isl
- Item W47 Bolaang, Mongondow, N Sulawesi Isl
- Item W48 Mongondow, N Sulawesi Isl
- Item W49 Gorontalo, N Sulawesi Isl
- Item W50 Gorontalo, N Sulawesi Isl
- Item W51
- Item W52 Badjao, Celebes sea
- Item W53 Gorontalo, N Sulawesi Isl
- Item W63 Toli Toli, N. Sulawesi Isl
- Item W65 Toli Toli, N. Sulawesi Isl
- Item W66 Sulawesi Isl
- Item W67 Toli Toli, N. Sulawesi Isl (Leiden muzeum)
- Item W79 Gorontalo, N Sulawesi Isl
- Item W80 Gorontalo, N Sulawesi Isl
- Item W81 Gorontalo, N Sulawesi Isl
- Item W82 Gorontalo, N Sulawesi Isl (Indonesia heritage)
- Item W83 Gorontalo, N Sulawesi Isl Isl
- Item W84 Sulawesi ? Borneo? – Roma Museum
- Item W85 Gorontalo, N Sulawesi Isl
- Item W86 Gorontalo, N Sulawesi Isl
- Item W87 Mongondow, Kotamobagu, N Sulawesi Isl
- Item W88 Mongondow, Kotamobagu, N Sulawesi Isl
- Item W89 Mongondow, Kotamobagu, N Sulawesi Isl

- Item W92 Gorontalo, N Sulawesi Isl
- Item W93 Gorontalo, N Sulawesi Isl
- Item W94 Manado, NE Sulawesi Isl
- Item W95 Gorontalo, N Sulawesi Isl
-
- Item W97 Gorontalo, N Sulawesi Isl
- Item W98 Gorontalo, N Sulawesi Isl
- Item W99 Gorontalo, N Sulawesi Isl

http://intheqapbetween.free.fr/pierre/GAMBUS_PROJECT/09_PORTFOLIO_part9
http://intheqapbetween.free.fr/pierre/GAMBUS/PROJECT/09b_PORTFOLIO_part9
http://intheqapbetween.free.fr/pierre/GAMBUS/PROJECT/09c_PORTFOLIO_part9
http://intheqapbetween.free.fr/pierre/GAMBUS/PROJECT/09d_PORTFOLIO_part9
http://intheqapbetween.free.fr/pierre/GAMBUS/PROJECT/09e_PORTFOLIO_part9

PART9 : JAVA

- Item J00 Java
- Item J01 Java
- Item J02 Java
- Item J03 Java
- Item J04 Java (Leiden Museum)
- Item J05 Surakarta, Java
- Item J06 Indonesia ?, TBD
- Item J07 Bandung, Java
- Item J08 Surakarta, Java
- Item J09 Surakarta, Java
- Item J10 Pekalongan, Java
- Item J11 Cikeas, W Java
- Item J12 Endo SUANDA, Bandung, Java
- Item J13 Endo SUANDA, Bandung, Java
- Item J14 Endo SUANDA, Bandung, Java
- Item J15 Yogyakarta, Java
- Item J16 Indonesia
- Item J17 Karawang, Java
- Item J18 Karawang, Java
- Item J19 Jakarta / Yogyakarta, Java
- Item J20 Jakarta, Java
- Item J21 mandolin like, Java
- Item J22 Malang, E. Java
- Item J23 Malang, E. Java
- Item J24 Bantang, E. Java
- Item J25 Balongan, W. Java
- Item J26 Jakarta, Java
- Item J27 Jakarta, Java
- Item J28 Pandangan, E.Java
- Item J29 Bongowoso, E.Java
- Item J30 Jakarta, Java
- Item J31 West Jakarta, Java
- Item J35 Bongowoso, E.Java
- Item J36 Grudo, Java
- Item J37 Java ?
- Item J38 Java ?
- Item J39 Java
- Item J40 Java
- Item J41 Tisnogambar, Java
- Item J42 Kota Tua, Java
- Item J43 Banten, W. Java
- Item J44 Banten, W. Java
- Item J45 Java
- Item J46 Wonosobo, W. Java
- Item J47 Pulau Pangerungan Besar, Madura
- Item J48 Bondowoso, Java
-
-

- Item J50 toy instrument, Cipacing, W. Java
- Item J51 souvenir lute, Java ?
- Item J52 souvenir lute, Java ?
- Item J53 souvenir lute, Java ?
- Item J54 souvenir lute, Java ?
- Item J55 souvenir lute, Java ?
- Item J56 souvenir lute, Java ?
- Item J57 souvenir lute, Java ?
-

Item n°:

D58 a *Dambus* (Bangka Isl)

Lute maker : KUSYIADI?

Owner : Pak ZAIDI

Name : Dambus, Bangka Isl

Age / Year : 2000's

ITEM D58 unseen 8 strings instrument as used for Zapin like dance (*Dincak*) of villagers, in Belitung isl.

Pegbox is standard deer head shaped; the Peghead design is typical for Bangka, but soundboard made of wood.

Seemingly made by KUSYIADI:

---Wide bodied soundbox

--- varnished (pine?) wood soundboard.

---old style pegs

Diam. Di = about 250mm

Le = about 900 mm

Lm= about 40 mm

Pi=about 90 mm



Item n°:

D58 a *Dambus* (Bangka Isl)

Lute maker : KUSYIADI?

Owner : Pak ZAIDI

Name : Dambus, Bangka Isl

Age / Year : 2000's

ITEM 658 unseen 8 strings instrument as used for Zapin like dance (*Dincak*) of villagers, in Belitung isl. Pegbox is standard deer head shaped; the Peghead design is typical for Bangka, but soundboard made of wood. Seemingly made by KUSYIADI:

- Wide bodied soundbox
- varnished (pine?) wood soundboard.
- old style pegs

Diam. Di = ~250mm
Lm= ~ 40 mm

Le = ~ 900 mm
Pi= ~ 90 mm



Item n°:

D58 b *Dambus* (Bangka Isl)

Lute maker : KUSYIADI

Owner : Reza SAPUTRA

Name : Dambus, Bangka Isl



Item n°:

D08 a *Dambus* (Bangka Isl) Lute maker : KUSYADI Owner : TBD

Name : Dambus, Panang, Bangka Isl

Age / Year : 2018

ITEM D08, smallest ITEM by maker KUSYADI ever observed 8strings variant as used for Zapin like dance (*Dincak*) of villagers, in Belitung isl. Pegbox is possibly standard deer head shaped; the Peghead design is typical for Bangka, but soundboard made of wood. Wood : ??? (Photo youtube)

---8 guitar tuners

--- varnished (pine?) wood soundboard

Diam. D_i = ~ 180mm L_e = ~ 900 mm

L_m = ~ 40 mm P_i = ~ 120 mm



Item n°:

D9D

Dambus (Bangka Isl)

Lute maker : KUSYADI

Owner : TBD

Name : Dambus, Pangkalpinang, Bangka Isl

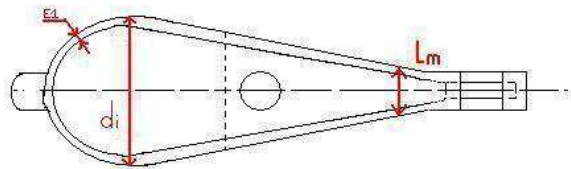
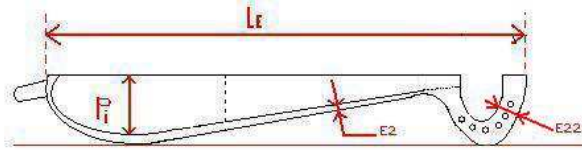

Age / Year : 2018?

ITEM D9D, narrowest ITEM by maker KUSYADI ever observed, possibly inspired by ZAROTI's production. 8 strings variant as used for Zapin like dance (**Dincak**) of villagers, in Belitung isl. Pegbox is possibly standard deer head shaped; the Peghead design is typical for Bangka, but soundboard made of wood. Wood : ??? (Photo youtube)

---8 guitar tuners

--- varnished (pine?) wood soundboard

Diam. D_i = ~ 150mm L_e = ~ 900 mm

L_m = ~ 40 mm

P_i = ~ 120 mm



Item n°:

D10 a **Dambus** (Bangka Isl)

Lute maker : KUSYIADI

Owner : unknown

1 of 2

Name : Dambus, Panang, Bangka Isl



Age / Year : observed 2013

ITEM 610 8 strings instrument as used for Zapin like dance (**Dincak**) of villagers, in Belitung isl. Wider than ITEM 633. Pegbox is standard deer head shaped; the Peghead design is typical for Bangka, but soundboard made of wood.
---8 pen-like pegs for 8 strings (3 choirs +2)
--- varnished (pine?) wood soundboard
Wood : ???

Diam. Di = ~ 250mm
Lm= ~ 40 mm

Le = ~ 900 mm
Pi= ~ 150 mm

(Photo Youtube)





Age / Year : observed 2013

ITEM 610: 8 strings instrument as used for Zapin like dance (*Dincak*) of villagers, in Belitung isl. Wider than ITEM 633. Pegbox is standard deer head shaped; the Peghead design is typical for Bangka, but soundboard made of wood.

---8 pen-like pegs for 8 strings (3 choirs +2)

--- varnished (pine?) wood soundboard

Wood : ??? (Photo Youtube)

Diam. Di = ~ 250 mm / Le = ~ 900 mm / Lm= ~ 40 mm / Pi= ~ 150 mm

Item n°: D10 b **Dambus** (Bangka Isl) Lute maker : KUSYIADI? Owner : Cak Macak troupe **2 of 2**



Name : Dambus, Panang, Bangka Isl

Age / Year : 2017

ITEM D10: Thin, 10 strings instrument as used for Zapin like dance (**Dincak**) of villagers, in Belitung isl. Wider than ITEM D33.

Pegbox is standard deer head shaped; the Peghead design is typical for Bangka, but soundboard made of wood.

---8 pen-like pegs for 8 strings (3 choirs +2)

--- varnished (pine?) wood soundboard

Wood : ??? (Photo Youtube)

Diam. Di = ~ 250 mm / Le = ~ 900 mm

Lm= ~ 40 mm / Pi= ~ 150 mm





Age / Year : 2013, 2017

ITEM D09b ITEM by KUSYADI, - OVOID SHAPED BODY – NO LAYERED FINGERBOARD . 8 strings instrument as used for Zapin like dance (**Dincak**) of villagers, in Belitung isl. Pegbox is standard deer head shaped; the Peghead design is typical for Bangka, but soundboard made of wood.

---8 guitar tuners (3 choirs +2)

--- varnished (pine?) wood soundboard . ITEM 609b: NO LAYERED FINGERBOARD. Wood : ???

Observed in a videoclip about the lute making in Panangkinalpang.

Diam. Di = ~ 250mm

Le = ~ 900 mm

Lm= ~ 40 mm

Pi= ~ 120 mm



Item n°:

D09 a **Dambus** (Bangka Isl)

Lute maker : KUSYIADI?

Owner : Andra MEDA

1 of 7

Name : Dambus, Panang, Bangka Isl

Age / Year : 2000's

ITEM D09 unseen 8 strings instrument as used for Zapin like dance (**Dincak**) of villagers, in Belitung isl. Wider than ITEM D33.

Pegbox is standard deer head shaped; the Peghead design is typical for Bangka, but soundboard made of wood.

---8 guitar tuners (3 choirs +2)
--- varnished (pine?) wood soundboard

Wood : ???

Diam. Di = ~ 250mm

Le = ~ 900 mm

Lm= ~ 40 mm

Pi= ~ 120 mm

(Photo OLX)



Item n°:

D09 a Dambus (Bangka Isl)

Lute maker : KUSYIADI?

Owner : Andra MEDA

2 of 7

Name : Dambus, Panang, Bangka Isl

Age / Year : 2000's

ITEM 609a , 8 strings instrument as used for Zapin like dance (**Dincak**) of villagers, in Belitung isl. Wider than ITEM 633.

Pegbox is standard deer head shaped; the Peghead design is typical for Bangka, but soundboard made of wood.

---8 guitar tuners (3 choirs +2)

--- varnished (pine?) wood soundboard

Wood : ???

Diam. Di = ~ 250mm

Le = ~ 900 mm

Lm= ~ 40 mm

Pi= ~ 120 mm

(Photo instagram)



Item n°:

D09 b **Dambus** (Bangka Isl) Lute maker : KUSYIADI Owner : TBD **4 of 7**

Name : Dambus, Panang, Bangka Isl



Item n°:

D09 c

Dambus (Bangka Isl)

Lute maker : KUSYIADI

Owner : Andy MACHDAR

5 of 7

Name : Dambus, Pangkalpinang, Bangka Isl

Age / Year : 2013, 2017

ITEM D09c BEST SELLER (late evolution of ITEM 609a, alternate rose shape variant), 8-10 strings instrument as used for Zapin like dance (**Dincak**) of villagers, in Belitung isl. Wider than ITEM 633. Pegbox is standard deer head shaped; the Peghead design is typical for Bangka, but soundboard made of wood.

---8 guitar tuners (3 choirs +2)

--- varnished (pine?) wood soundboard

Variant C: DARK WOODEN FINGERBOARD. (Photo instagram)

Diam. Di = ~ 250mm / Le = ~ 900 mm / Lm= ~ 40 mm / Pi= ~ 120 mm





Age / Year : 2016

ITEM D09d (late evolution of ITEM 609a, alternate fingerboard, alternate rose shape variant), 8-10 strings instrument as used for Zapin like dance (**Dincak**) of villagers, in Belitung isl. Wider than ITEM 633. Pegbox is standard deer head shaped; the Peghead design is typical for Bangka, but soundboard made of wood.

---8 guitar tuners (3 choirs +2)

--- varnished (pine?) wood soundboard

Variant C: DARK WOODEN FINGERBOARD. Wood : ??? (PhotoYOUTUBE)

Diam. Di = ~ 250mm / Le = ~ 900 mm / Lm= ~ 40 mm / Pi= ~ 120 mm

Item n°:

D09 e **Dambus** (Bangka Isl)

Lute maker : KUSYIADI

Owner : Andy MACHDAR

7 of 7

Name : Dambus, Pangkalpinang, Bangka Isl

Age / Year : 2016

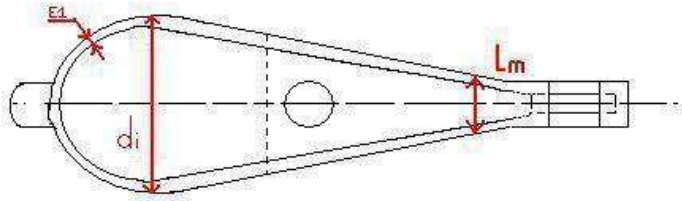
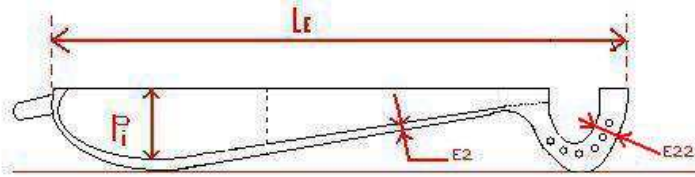

ITEM D09 e (late evolution of ITEM 609a, alternate rose shape variant), 8-10 strings instrument as used for Zapin like dance (**Dincak**) of villagers, in Belitung isl. Wider than ITEM 633. Pegbox is standard deer head shaped; the Peghead design is typical for Bangka, but soundboard made of wood.

---8 guitar tuners (3 choirs +2)

--- varnished (pine?) wood soundboard

Variant C: DARK WOODEN FINGERBOARD. Wood : ??? (PhotoYOUTUBE)

Diam. D_i = ~ 250mm / L_e = ~ 900 mm /

L_m = ~ 40 mm / P_i = ~ 120 mm



Item n°:
D17 a *Dambus* (Bangka Isl) Lute maker : KUSYIADI? Owner : TBD (Pangkalpinang)

Name : Dambus, Pangkalpinang, Bangka Isl

Age / Year : 2000's

ITEM 617a , 10 strings variant as used for Zapin like dance (*Dincak*) of villagers, in Belitung isl. Wider than ITEM 633.

Pegbox is standard deer head shaped; the Peghead design is typical for Bangka, but soundboard made of wood.

---10 gu gitar tuners
--- varnished (pine?) wood soundboard
Wood : ???

Diam. Di = ~ 300mm Le = ~ 900 mm
Lm= ~ 40 mm Pi= ~ 120 mm
(Photo instagram)



Item n°:

D17 a Dambus (Bangka Isl)

Lute maker : KUSYIADI?

Owner : TBD (Pangkalpinang)

Name : Dambus, Pangkalpinang, Bangka Isl

Age / Year : 2000's

ITEM 617a , 10 strings variant as used for Zapin like dance (**Dincak**) of villagers, in Belitung isl. Wider than ITEM 633.

Pegbox is standard deer head shaped; the Peghead design is typical for Bangka, but soundboard made of wood.

---10 gu gitar tuners

--- varnished (pine?) wood soundboard

Wood : ???

Diam. Di = ~ 300mm

Le = ~ 900 mm

Lm= ~ 40 mm

Pi= ~ 120 mm

(Photo instagram)



D17 b *Dambus* (Bangka Isl)

Lute maker : KUSYIADI

Owner : Andra MEDA

1 of 2



Age / Year : 2000's

ITEM 617b , 10 strings variant as used for Zapin like dance (*Dincak*) of villagers, in Belitung isl. Wider than ITEM 633.

Pegbox is standard deer head shaped; the Peghead design is typical for Bangka, but soundboard made of wood. Wood : ???

---10 guitar tuners

---cWOOD LAYERED FINGERBOARD

Diam. Di = ~ 300mm

Le = ~ 900 mm

Lm= ~ 40 mm

Pi= ~ 120 mm

(Photo instagram)



Item n°:

D17 C **Dambus** (Bangka) Lute maker : KUSYIADI Owner : KUSYIADI / O.G.KEMBANG PELAWAN 2 of 2

Name : Dambus, Panang, Bangka Isl

Age / Year : 2017

ITEM 617c, 10 strings variant as used for Zapin like dance (**Dincak**) of villagers, in Belitung isl. Wider than ITEM 633.

Pegbox is standard deer head shaped; the Peghead design is typical for Bangka, but soundboard made of wood.

---10 guitar tuners

--- varnished (pine?) wood soundboard

Wood : ???

Diam. Di = ~ 280mm Le = ~ 900 mm

Lm= ~ 40 mm Pi= ~ 120 mm

(Photo instagram)



Item n°:

D63 a *Dambus* (Bangka Isl)

Lute maker : KUSYIADI

Owner : for sale

Name : Dambus, Panang, Bangka Isl

Age / Year : 2017

ITEM D63 ("PEN-SHAPED PEGS" VARIANT OF ITEM D59) , 10 strings variant as used for Zapin like dance (*Dincak*) of villagers, in Belitung isl. Wider than ITEM 610, 633.

Pegbox is standard deer head shaped; the Peghead design is typical for Bangka, but soundboard made of wood. (Photo Youtube)

---10 pen-like pegs for 10 strings
--- varnished (pine?) wood soundboard

Diam. Di = ~330 mm

Le = ~900 mm

Lm= ~ 40 mm

Pi= ~ 150 mm





Age / Year : 2017

ITEM D63 ("PEN-SHAPED PEGS" VARIANT OF ITEM D59) , 10 strings variant as used for Zapin like dance (*Dincak*) of villagers, in Belitung isl. Wider than ITEM 610, 633. Pegbox is standard deer head shaped; the Peghead design is typical for Bangka, but soundboard made of wood.
 ---10 pen-like pegs for 10 strings
 --- varnished (pine?) wood soundboard

Diam. Di = ~320 mm / Le = ~900 mm
 Lm= ~ 40 mm / Pi= ~ 150 mm



Item n°:

D63 c *Dambus* (Bangka Isl)

Lute maker : KUSYIADI

Owner : for sale

Name : Dambus, Panang, Bangka Isl

Age / Year : 2017

ITEM D63 "c" variant (ALTERNATE FINGERBOARD CONSTRUCTION) , 10 strings variant as used for Zapin like dance (*Dincak*) of villagers, in Belitung isl. Wider than ITEM 610, 633. ALTERNATE ROSE SHAPE. Pegbox is standard deer head shaped; the Peghead design is typical for Bangka, but soundboard made of wood.

---10 pen-like pegs for 10 strings

--- varnished (pine?) wood soundboard
ALTERNATE FINGERBOARD PATTERN Wood : ??? (Photo Youtube)

Diam. Di = ~300mm / Le = ~900 mm
Lm= ~ 40 mm / Pi= ~ 150 mm



D59 a **Dambus** (Bangka Isl) Lute maker : KUSYIADI Owner : TBDAge / Year : 2017

ITEM D59 unseen 10 strings instrument as used for Zapin like dance (**Dincak**) of villagers, in Belitung isl. Wider than ITEM 633. ALTERNATE ROSE SHAPE. Pegbox is standard deer head shaped; the Peghead design is typical for Bangka, but soundboard made of wood. Wood : ???

---10 guitar tuners

--- Varnished (pine?) wood soundboard.

Diam. Di = ~ 320 mm Le = ~ 900 mm
 Lm= ~ 40 mm Pi= ~ 120 mm

(Photo instagram)

Item n°:

D59 a-z Dambus (Bangka Isl)

Lute maker : KUSYIADI

Owner : TBD

Name : Dambus, Panang, Bangka Isl

Age / Year : observed 2019

ITEM D59 "b" variant ("GUITAR TUNERS" VARIANT of ITEM D63) unseen 10 strings instrument as used for Zapin like dance (**Dincak**) of villagers, in Belitung isl. Wider than ITEM 633. ALTERNATE ROSE SHAPE. Pegbox is standard deer head shaped; the Peghead design is typical for Bangka, but soundboard made of wood. Wood : ??? (Photo instagram)

---10 guitar tuners

--- Varnished (pine?) wood soundboard.

Diam. Di = ~ 320 mm / Le = ~ 900 mm / Lm= ~ 40 mm / Pi= ~ 120 mm

